

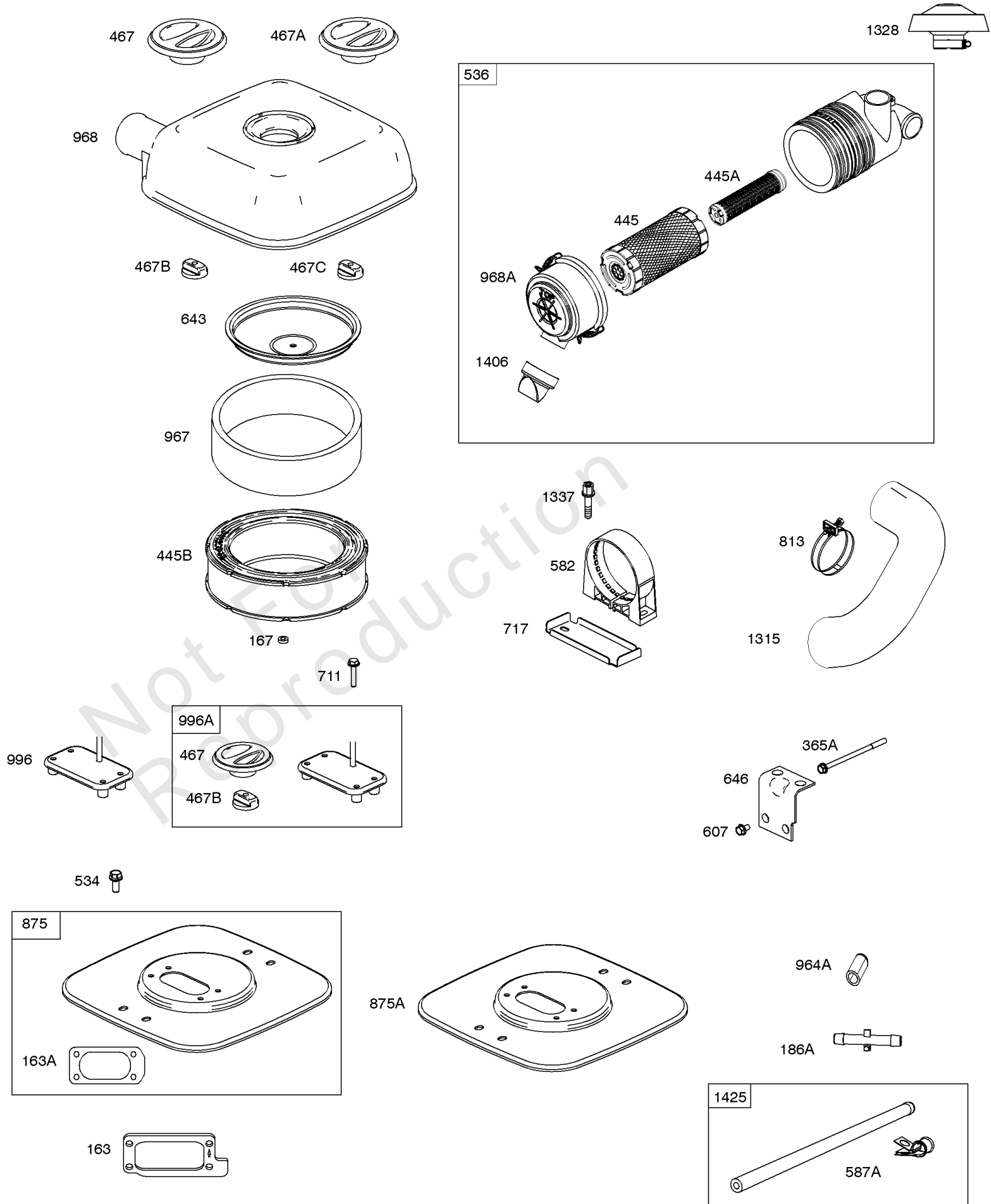

Parts Manual

Mfg. No: 541477-1112-J1

| Model Components | Page |
|---|-------------|
| Air Cleaners, Purge Hose. | 4 |
| Blower Housings, Key Switches, Rotating Screens. | 6 |
| Carburetor Overhaul Kit, Engine/Valve Gasket Sets. | 8 |
| Carburetors, Carburetor Spacer. | 10 |
| Control Brackets, Springs, Throttle Rod. | 14 |
| Crankcase Cover, Oil Cooler, Camshaft. | 16 |
| Cylinder Heads, Rocker Covers. | 20 |
| Cylinder, Piston/Rings/Connecting Rod, Crankshaft. | 24 |
| Exhaust System. | 28 |
| Flywheel, Air Guides, Stub Shaft. | 30 |
| Intake Manifold, Intake Elbows, Fuel Supply. | 32 |
| Replacement Engine - US & Canada. | 34 |
| Starter Motor, Wire Harness's, Armatures. | 35 |
| Model 54-61 Engine Accessories Catalog. | 37 |
| Maintenance Kits. | 38 |
| Lubrication. | 40 |
| Oil Filter Side Outlet Mufflers. | 42 |
| Center Outlet Mufflers. | 44 |
| Starter Side Outlet Mufflers. | 46 |
| Muffler Bracket Kits. | 48 |
| Speed Control. | 50 |
| Electrical. | 52 |
| Stub Shafts. | 54 |
| Spark Arrester/Deflector. | 56 |
| Air Intake. | 58 |
| Guarding. | 60 |
| Electronic Throttle Kit. | 62 |



Air Cleaners, Purge Hose

| REF NO | PART NO | QTY | DESCRIPTION |
|--------|---------|-----|--|
| 163 | 807375 | | GASKET, Air Cleaner |
| 167 | 841855 | | SEAL, Air Cleaner Nut -Used Before Code Date 14012800 |
| 186A | 845121 | | CONNECTOR, Hose -(EVAP) |
| 365A | 841853 | | SCREW -(Carburetor/Throttle Body) (M6x103mm) |
| 445 | 841497 | | FILTER, A/C Cartridge |
| 445A | 821136 | | FILTER, A/C Cartridge |
| 445B | 692519 | | FILTER, A/C Cartridge |
| 467 | 846008 | | KNOB, Air Cleaner Cover -(M8) -Used After Code Date 14012700 |
| 467A | 841846 | | KNOB, Air Cleaner Cover -(M6) -Used Before Code Date 14012800 |
| 467B | 846007 | | KNOB, Air Cleaner Cover -(M8) -Used After Code Date 14012700 |
| 467C | 844618 | | KNOB, Air Cleaner Cover -(M6) -Used Before Code Date 14012800 |
| 534 | 692062 | | SCREW -(Air Cleaner) |
| 536 | 809670 | | CLEANER, Air |
| 582 | 809878 | | CLAMP, Air Cleaner |
| 587A | 807116 | | CLAMP, Tube |
| 607 | 841233 | | SCREW -(Air Cleaner Brace) |
| 643 | 844932 | | RETAINER, Air Cleaner |
| 646 | 841849 | | BRACE, Air Cleanr |
| 711 | 807385 | | SCREW -(Carburetor Shield) (M6x35mm) |
| 717 | 841886 | | BRACKET, Air Cleaner |
| 813 | 807376 | | CLAMP -(Air Cleaner Hose) |
| 875 | 843118 | | BASE, Air Cleaner -Used After Code Date 06062200 |
| 964A | 590799 | | CAP, Connector |
| 967 | 692520 | | FILTER, Pre Cleaner |
| 968 | 841847 | | COVER, Air Cleaner |
| 968A | 842621 | | COVER, Air Cleaner |
| 996 | 846006 | | SHIELD, Carburetor -(M8) -Used After Code Date 14012700 |
| 996A | 846013 | | SHIELD, Carburetor -(M8) -Used After Code Date 06062200 -Used Before Code Date 14012800 |
| 1315 | 809905 | | HOSE, Air Cleaner |
| 1328 | 809907 | | CAP, A/C Rain |
| 1337 | 807382 | | SCREW -(Air Cleaner Clamp) |
| 1406 | 842623 | | VALVE, Debris |

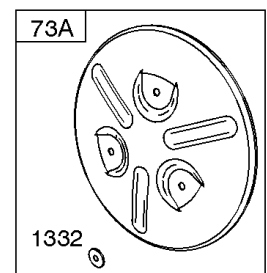
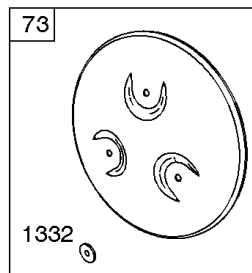
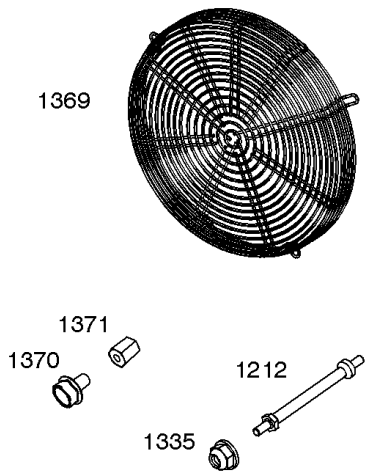
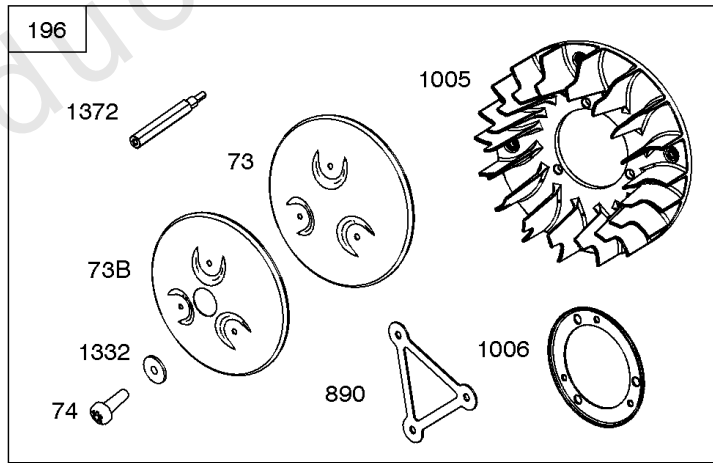
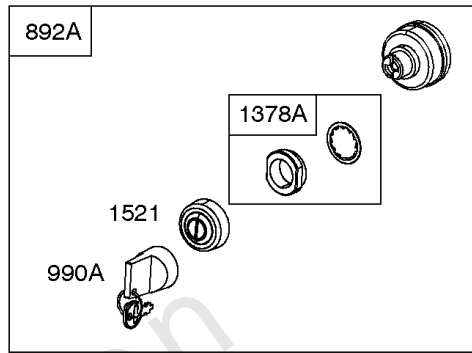
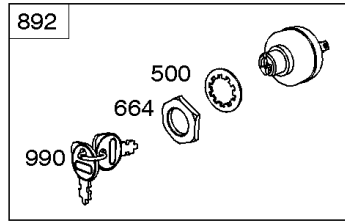
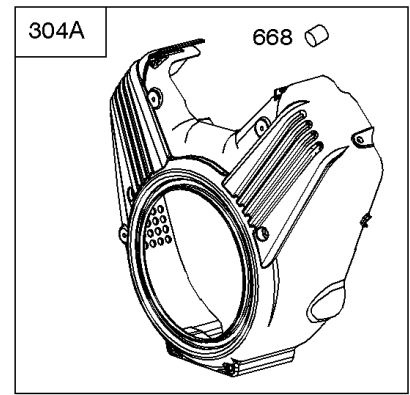
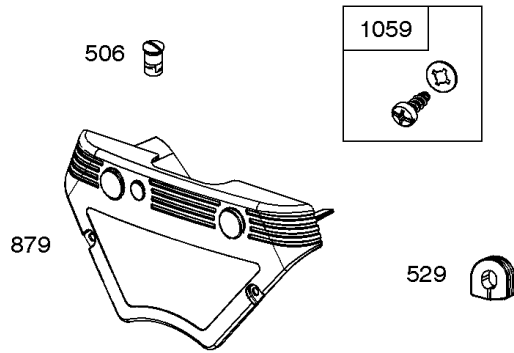
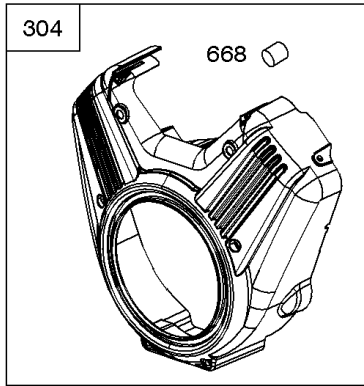

Blower Housings, Key Switches, Rotating Screens

| REF NO | PART NO | QTY | DESCRIPTION |
|--------|---------|-----|---|
| 73 | 841840 | | SCREEN, Rotating -Used After Code Date 05010900 |
| 74 | 809947 | | SCREW -(Rotating Screen) |
| 196 | 847200 | | GUARD, Flywheel Fan -Used Before Code Date 05011000 |
| 304 | 846964 | | HOUSING, Blower -(Non Oil Cooler) -Used After Code Date 11040700 |
| 304 | 809959 | | HOUSING, Blower -(Non Oil Cooler) -Used Before Code Date 11040700 |
| 500 | 691086 | | WASHER -(Key Switch) |
| 506 | 809957 | | SCREW -(Carburetor/EFI Cover) -Used Before Code Date 11040800 |
| 529 | 690744 | | GROMMET -(Magneto Armature Wires) |
| 664 | 691087 | | NUT -(Key Switch) |
| 668 | 841974 | | SPACER -(Blower Housing) |
| 879 | 809955 | | COVER, Carburetor/EFI |
| 890 | 809987 | | BRACKET, Support |
| 892A | 847448 | | SWITCH, Key |
| 990A | 847146 | | SET, Key |
| 1005 | 846996 | | FAN, Flywheel -Used After Code Date 15080600 |
| 1006 | 847198 | | RETAINER, Fan |
| 1059 | 845300 | | KIT, Screw/Washer -Used After Code Date 11040700 |
| 1212 | 809958 | | STUD -(Blower Housing) |
| 1332 | 809948 | | WASHER -(Rotating Screen) |
| 1335 | 690939 | | NUT -(Blower Housing) |
| 1369 | 842858 | | GUARD, Flywheel Fan |
| 1370 | 841233 | | SCREW -(Flywheel Fan Guard) |
| 1371 | 841537 | | NUT -(Flywheel Fan Guard) |
| 1372 | 809946 | | STUD -(Rotating Screen) |
| 1378A | 847144 | | SET, Washer/Nut -(Key Switch) |
| 1521 | 847150 | | CAP, Switch |

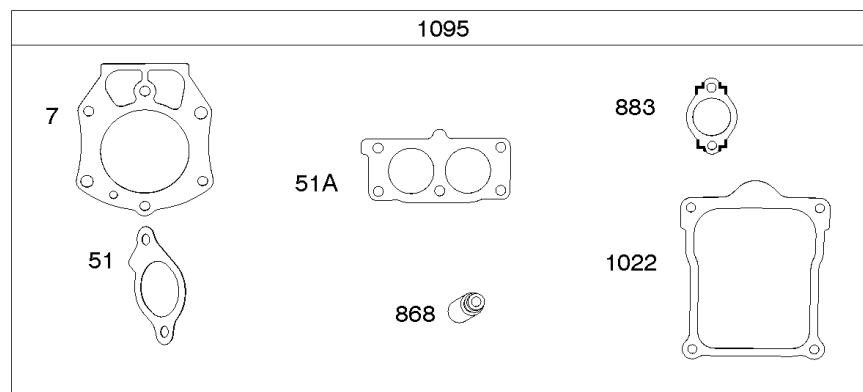
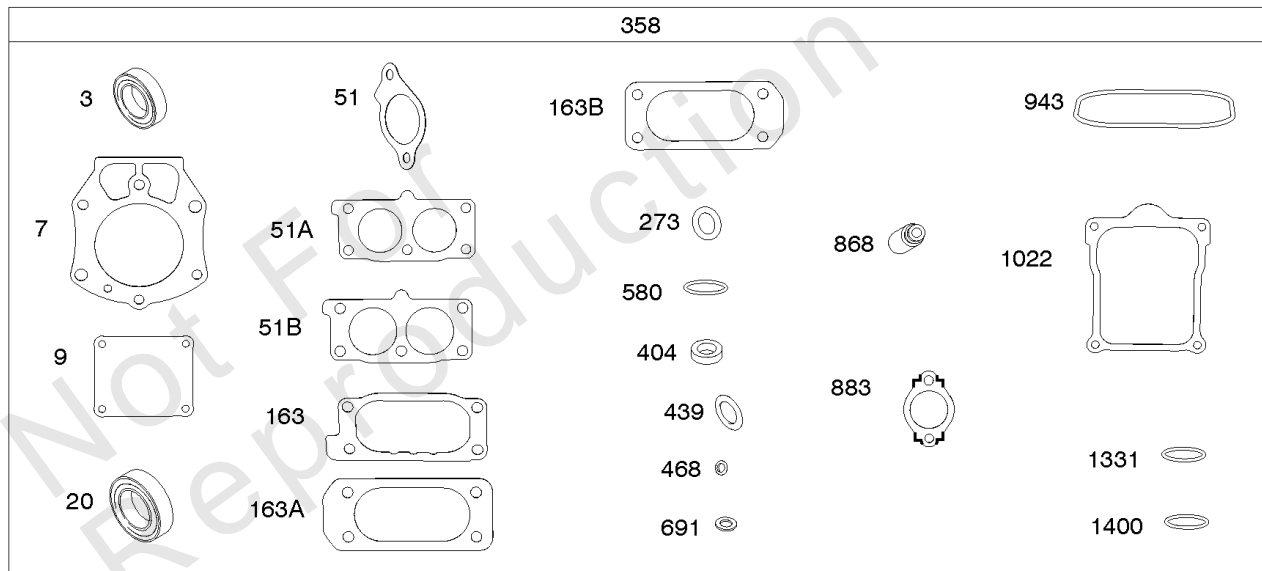
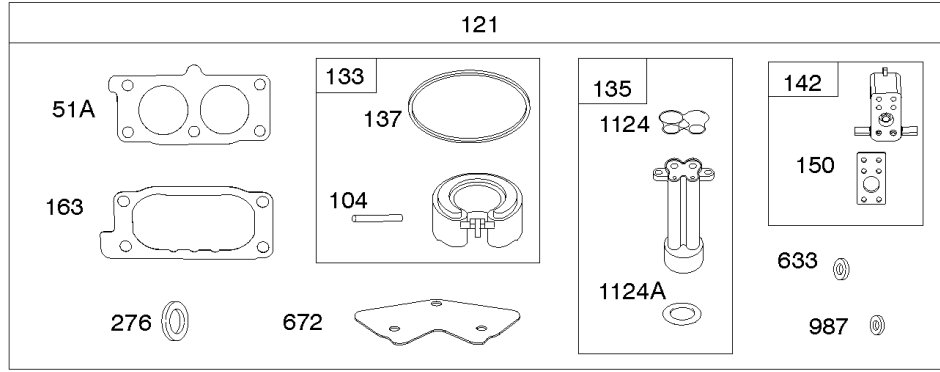

Carburetor Overhaul Kit, Engine/Valve Gasket Sets

| REF NO | PART NO | QTY | DESCRIPTION |
|--------|---------|-----|---|
| 3 | 841596 | | SEAL, Oil -(Magneto Side) |
| 7 | 809730 | | GASKET, Cylinder Head |
| 9 | 842545 | | GASKET, Breather |
| 20 | 841596 | | SEAL, Oil -(PTO Side) |
| 51 | 841592 | | GASKET, Intake |
| 51A | 809910 | | GASKET, Intake |
| 51B | 841882 | | GASKET, Intake |
| 104 | 690882 | | PIN, Float Hinge |
| 121 | 841548 | | KIT, Carburetor Overhaul |
| 133 | 841545 | | FLOAT, Carburetor |
| 135 | 841646 | | TUBE, Fuel Transfer |
| 137 | 841651 | | GASKET, Float Bowl |
| 142 | 699726 | | NOZZLE, Carburetor -Used After Code Date 11020800 |
| 142 | 841648 | | NOZZLE, Carburetor -Used Before Code Date 11020900 |
| 150 | 841649 | | GASKET, Nozzle |
| 163 | 807375 | | GASKET, Air Cleaner |
| 273 | 690681 | | SEAL, O-Ring -(Oil Pump) |
| 276 | 695410 | | WASHER, Sealing |
| 358 | 841122 | | GASKET SET, Engine |
| 404 | 809436 | | WASHER -(Governor Crank) |
| 439 | 692154 | | O-RING, Oil Gallery -(Crankcase Cover/Sump or Cylinder Assembly) |
| 468 | 690690 | | SEAL, O-Ring -(Oil Pump Screen) |
| 580 | 809894 | | SEAL, O-Ring -(Oil Fill Cap) |
| 633 | 690722 | | SEAL, Choke/Throttle Shaft -(Choke Shaft) |
| 672 | 841655 | | GASKET, Carburetor Plate |
| 691 | 809287 | | SEAL, Governor Shaft |
| 868 | 691963 | | SEAL, Valve |
| 883 | 809872 | | GASKET, Exhaust |
| 943 | 690681 | | SEAL, O-Ring -(Oil Pump Cover) |
| 987 | 808183 | | SEAL, Choke/Throttle Shaft |
| 1022 | 809732 | | GASKET, Rocker Cover |
| 1095 | 843713 | | GASKET SET, Valve |
| 1124 | 841647 | | SEAL, O-Ring -(Fuel Transfer Tube) |
| 1124A | 841653 | | SEAL, O-Ring -(Fuel Transfer Tube) |
| 1331 | 809894 | | SEAL, O-Ring -(Fuel Pump) (Fuel Pump) |
| 1400 | 809894 | | SEAL, O-Ring -(Fuel Pump Cover) |

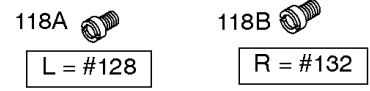
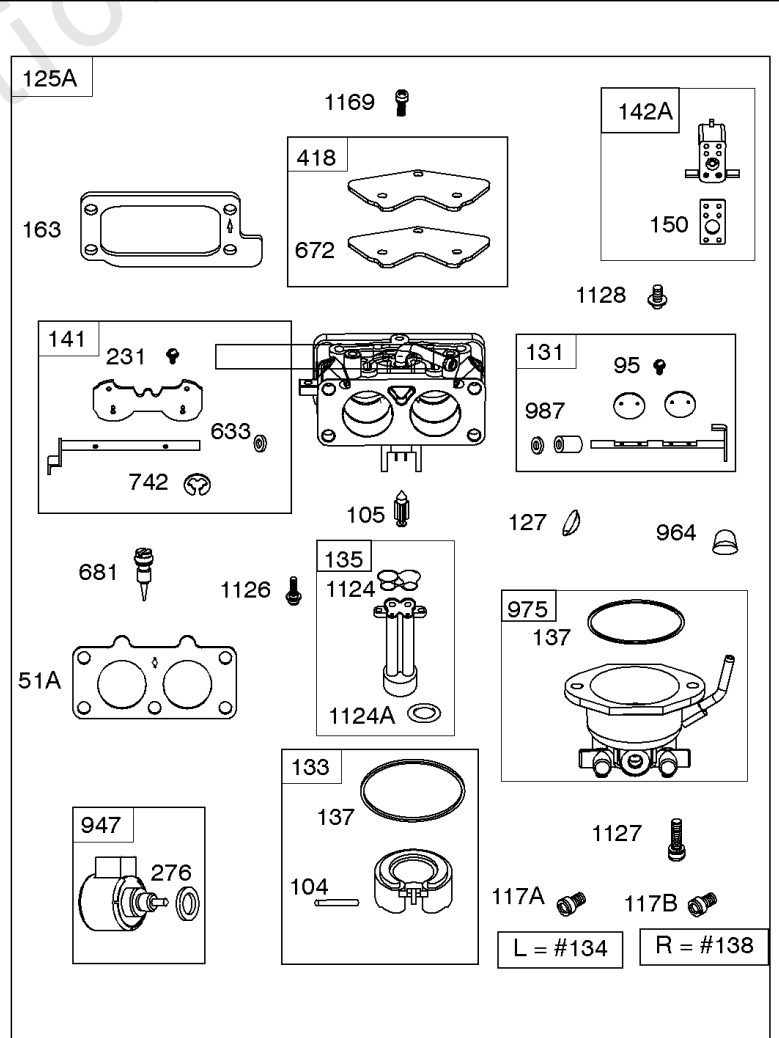
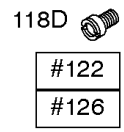
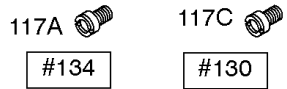
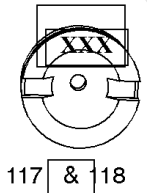
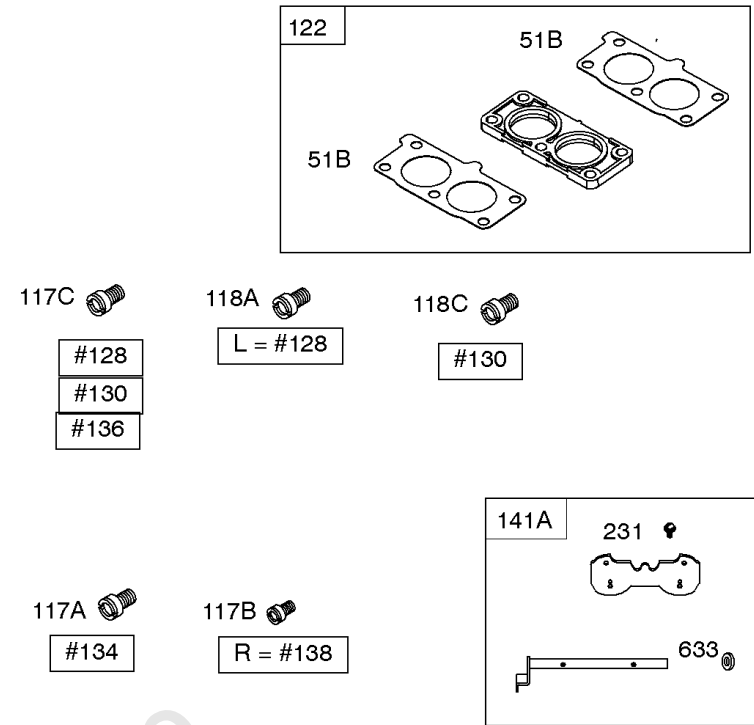
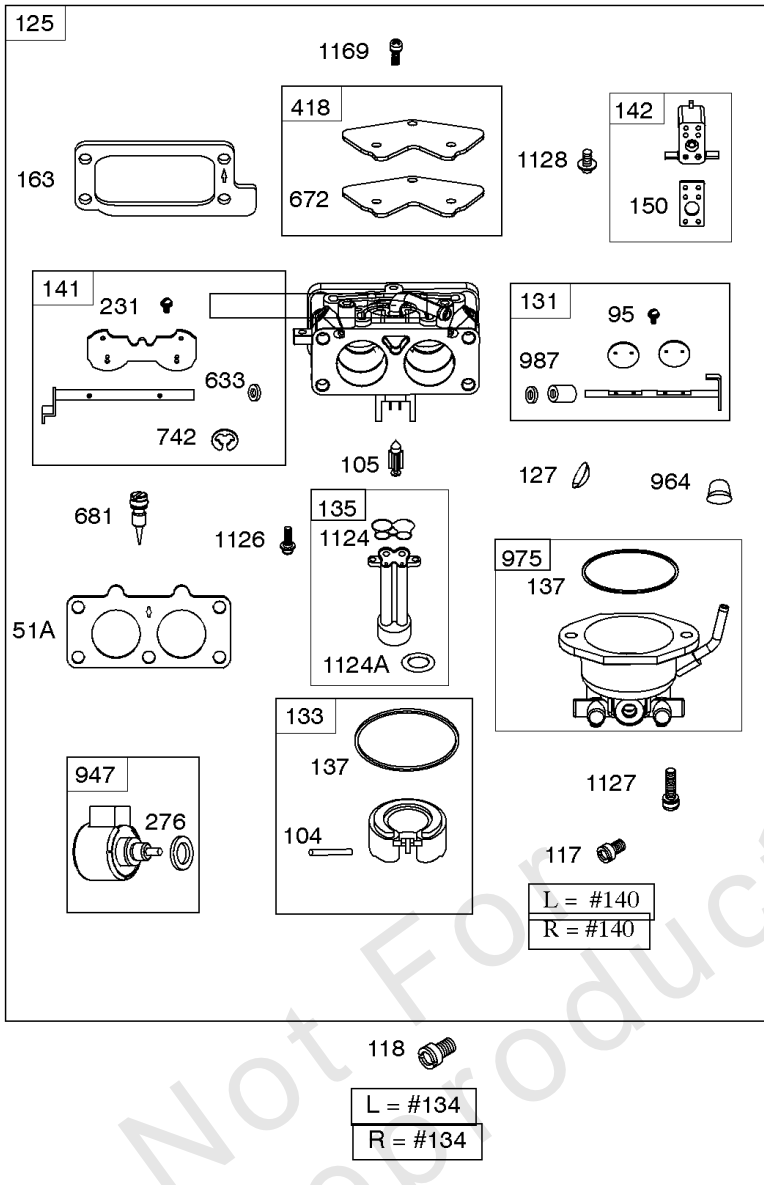

Carburetors, Carburetor Spacer

| REF NO | PART NO | QTY | DESCRIPTION |
|--------|---------|-----|---|
| 51A | 809910 | | GASKET, Intake |
| 51B | 841882 | | GASKET, Intake |
| 95 | 690718 | | SCREW -(Throttle Valve) |
| 104 | 690882 | | PIN, Float Hinge |
| 105 | 698537 | | VALVE, Float Needle |
| 117 | 845289 | | JET, Main -(Standard) (Left and Right Jet) (#140) |
| 117A | 842012 | | JET, Main -(Standard) (Left Jet) (#134) |
| 117B | 842634 | | JET, Main -(Standard) (Right Jet) (#138) |
| 117C | 842633 | | JET, Main -(Standard) (#136) |
| 117C | 842629 | | JET, Main -(Standard) (#130) |
| 118 | 842012 | | JET, Main -(High Altitude) (Left and Right Jet) (#134) |
| 118A | 842139 | | JET, Main -(High Altitude) (Left Jet) (#128) |
| 118B | 842630 | | JET, Main -(High Altitude) (Right Jet) (#132) |
| 118C | 842629 | | JET, Main -(High Altitude) (Left Jet) (#130) |
| 118D | 842627 | | JET, Main -(High Altitude) (Right Jet) (#122) |
| 118D | 842082 | | JET, Main -(High Altitude) (Left Jet) (#126) |
| 122 | 846245 | | SPACER, Carburetor |
| 125 | 845277 | | CARBURETOR |
| 127 | 844590 | | PLUG, Welch |
| 131 | 843562 | | KIT, Throttle Shaft |
| 133 | 841545 | | FLOAT, Carburetor |
| 135 | 841646 | | TUBE, Fuel Transfer |
| 137 | 841651 | | GASKET, Float Bowl |
| 141 | 844733 | | KIT, Choke Shaft -Used After Code Date 10043000 |
| 141A | 841549 | | KIT, Choke Shaft -Used Before Code Date 10050100 |
| 142 | 841648 | | NOZZLE, Carburetor -Used Before Code Date 11020900 |
| 142 | 699726 | | NOZZLE, Carburetor -Used After Code Date 11020800 |
| 150 | 841649 | | GASKET, Nozzle |
| 163 | 807375 | | GASKET, Air Cleaner |
| 231 | 690718 | | SCREW -(Choke Valve) |
| 276 | 695410 | | WASHER, Sealing |
| 418 | 843346 | | PLATE, Carburetor Cover |
| 633 | 690722 | | SEAL, Choke/Throttle Shaft -(Choke Shaft) |
| 672 | 841655 | | GASKET, Carburetor Plate |
| 681 | 845290 | | KIT, Needle Valve |
| 742 | 807001 | | RETAINER, E Ring |
| 947 | 841546 | | SOLENOID, Fuel |
| 964 | 807468 | | CAP, Carburetor -(Carburetor) |

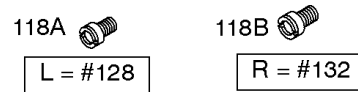
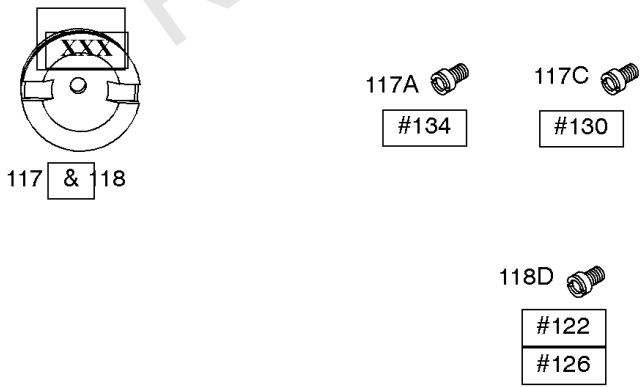
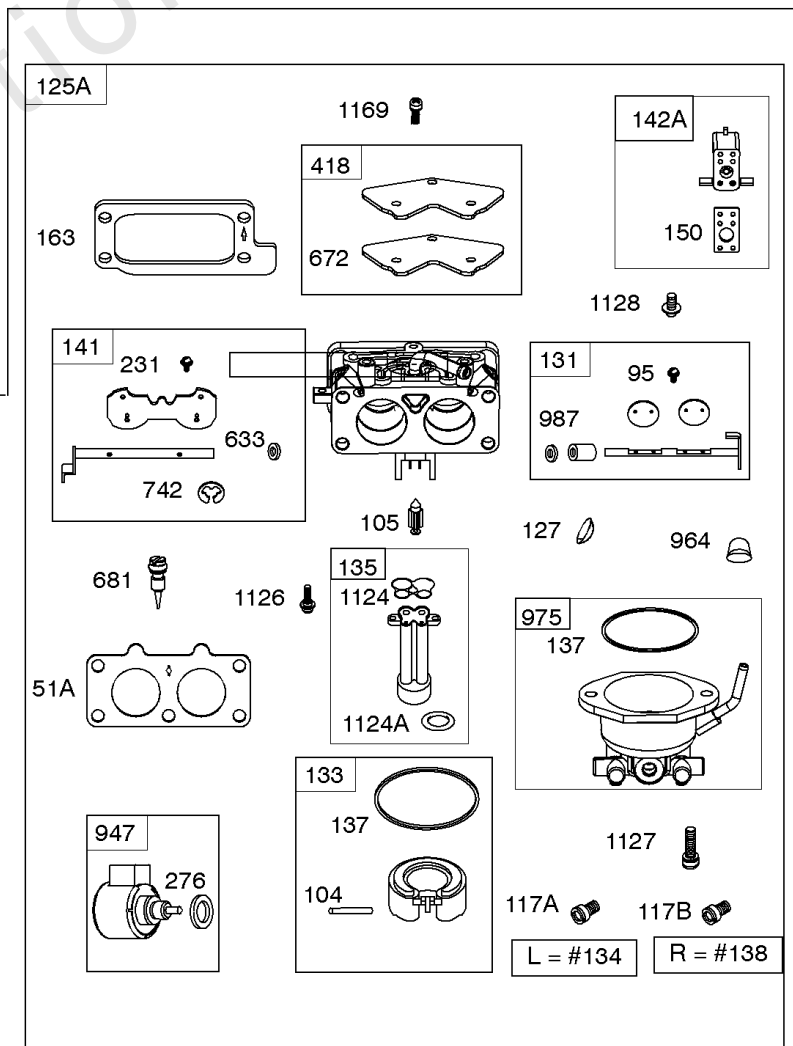
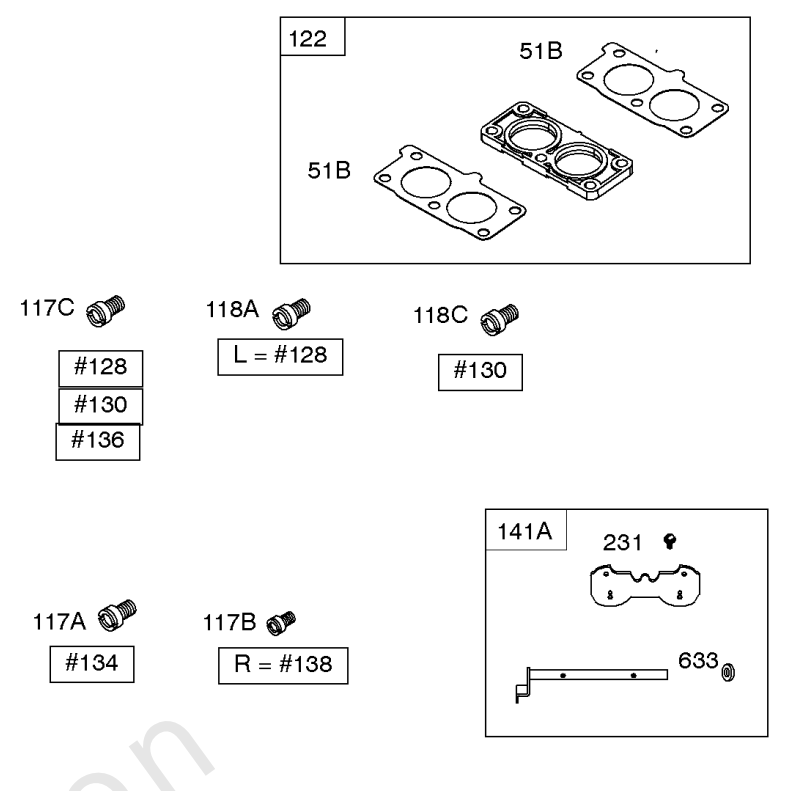
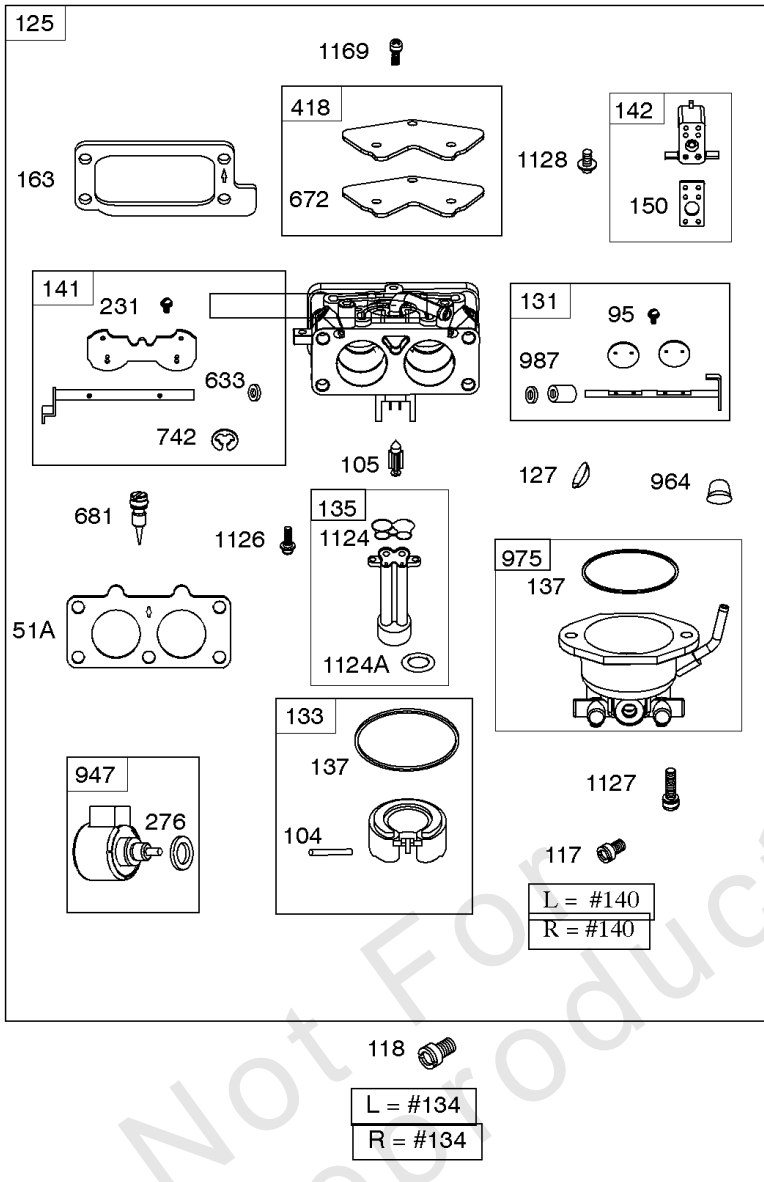

Carburetors, Carburetor Spacer

| REF NO | PART NO | QTY | DESCRIPTION |
|--------|---------|-----|---|
| 975 | 841650 | | BOWL, Float |
| 987 | 808183 | | SEAL, Choke/Throttle Shaft |
| 1124 | 841647 | | SEAL, O-Ring -(Fuel Transfer Tube) |
| 1124A | 841653 | | SEAL, O-Ring -(Fuel Transfer Tube) |
| 1126 | 841619 | | SCREW -(Fuel Transfer Tube) |
| 1127 | 841621 | | SCREW -(Float Bowl to Carburetor Body) |
| 1128 | 690990 | | SCREW -(Carburetor Nozzle) |
| 1169 | 690990 | | SCREW -(Carburetor Cover Plate) |

Not For Reproduction

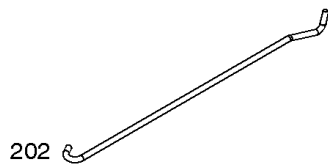
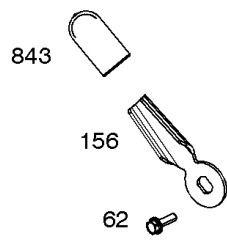
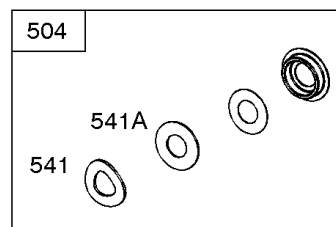
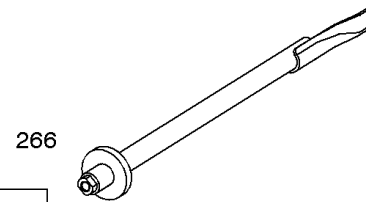
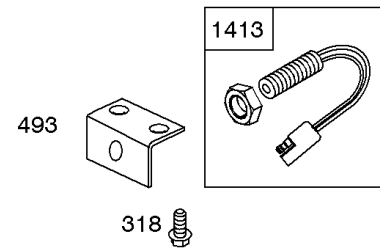
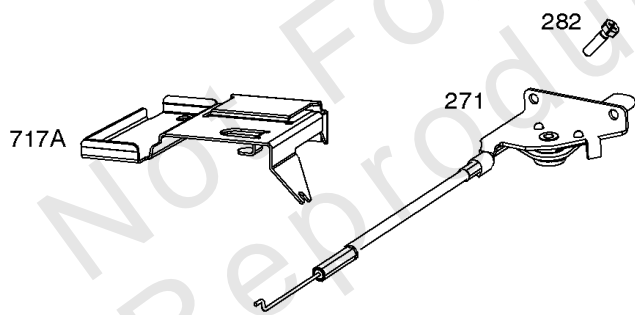
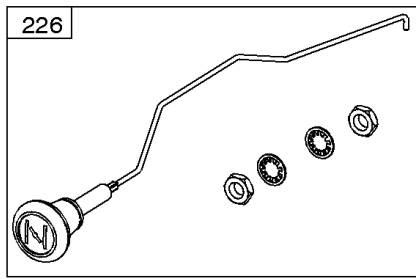
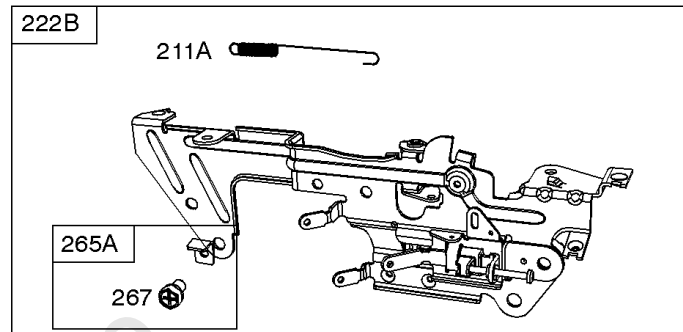
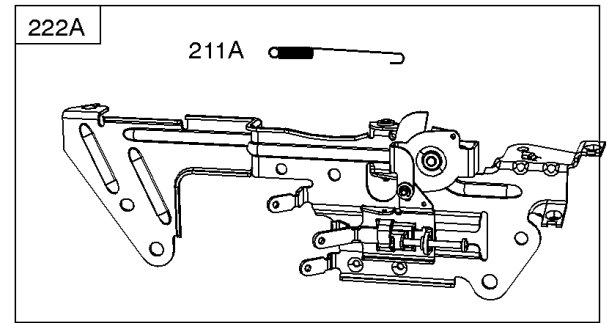
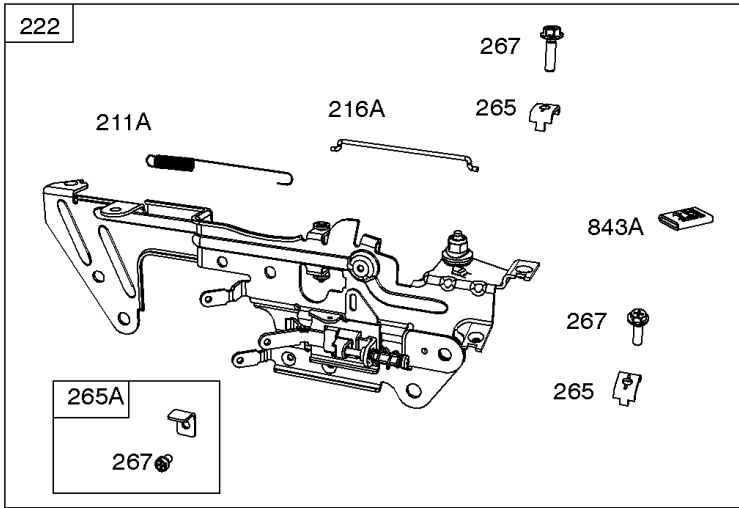

Control Brackets, Springs, Throttle Rod

| REF NO | PART NO | QTY | DESCRIPTION |
|--------|---------|-----|--|
| 62 | 841233 | | SCREW -(Speed Adjuster Lever) (M6x10mm) |
| 156 | 841522 | | LEVER, Control |
| 188 | 841233 | | SCREW -(Control Bracket) |
| 202 | 841322 | | LINK, Mechanical Governor |
| 209 | 841012 | | SPRING, Governor -(Yellow) |
| 211 | 809875 | | SPRING, Governed Idle -(White) |
| 211A | 690707 | | SPRING, Governed Idle -(Control Bracket) (White) |
| 216 | 809788 | | LINK, Choke |
| 222A | 841527 | | BRACKET, Control -Used Before Code Date 10060100 |
| 222B | 841528 | | BRACKET, Control -Used After Code Date 10053100 |
| 226 | 841613 | | ROD, Choke |
| 232 | 690545 | | SPRING/LINK, Governor |
| 265 | 691024 | | CLAMP, Casing |
| 265A | 841673 | | CLAMP, Casing |
| 266 | 841521 | | CONTROL, Throttle -Used Before Code Date 10060100 |
| 267 | 841552 | | SCREW -(Casing Clamp) (M5x20mm) |
| 271 | 692541 | | LEVER, Control |
| 282 | 841552 | | SCREW -(Control Lever) (M6x10mm) |
| 318 | 841233 | | SCREW -(Mounting Bracket) (Speed Sensor) |
| 493 | 842713 | | BRACKET, Mounting -(Speed Sensor) |
| 504 | 846156 | | WASHER -(Speed Adjuster Lever) |
| 541 | 841526 | | WASHER -(Speed Adjuster Lever) (Wave Washer) |
| 541A | 841525 | | WASHER -(Speed Adjuster Lever) (Flat Washer) |
| 561 | 690713 | | NUT -(Control Lever) |
| 717A | 842730 | | BRACKET, Air Cleaner |
| 843 | 842745 | | SLEEVE, Lever -(Speed Adjuster Lever) |
| 843A | 809672 | | SLEEVE, Lever -(Control Bracket) |

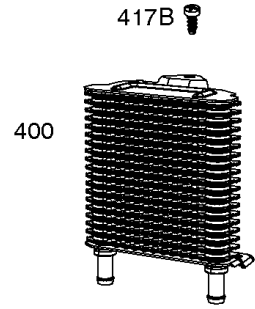
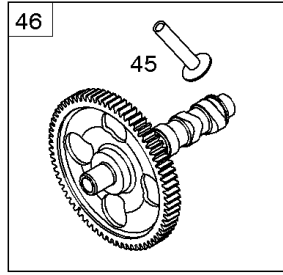
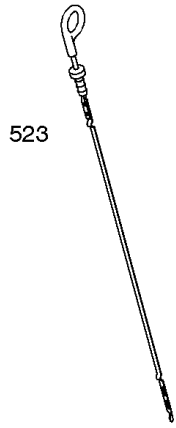

417B

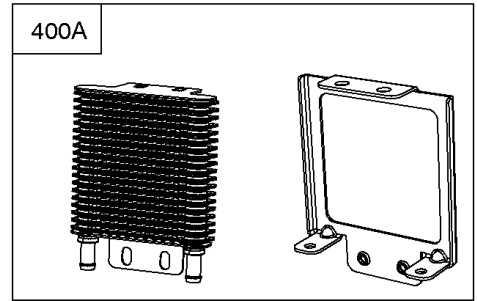

400A

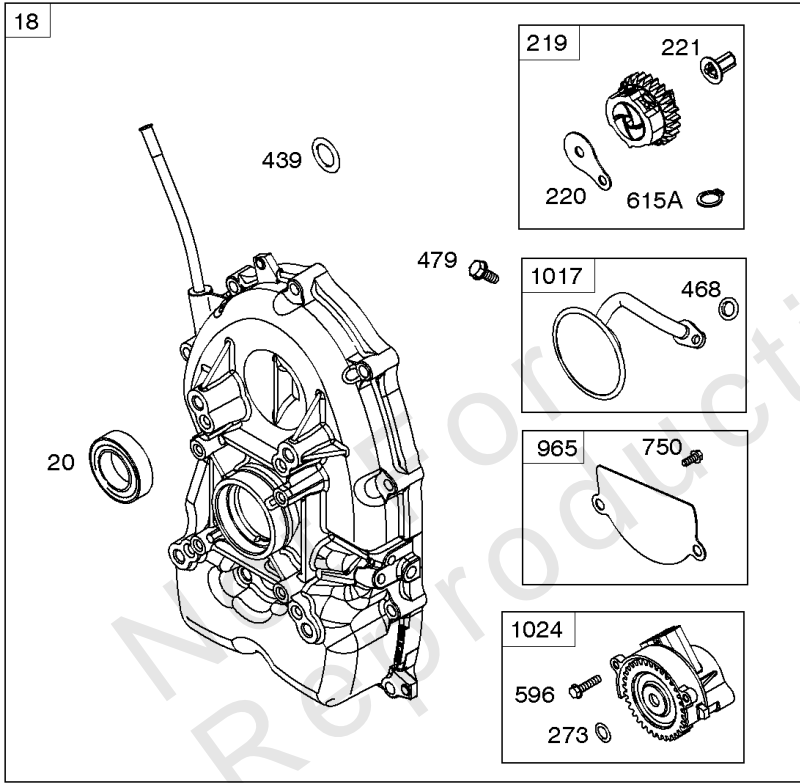

18

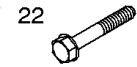
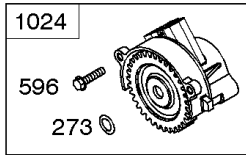
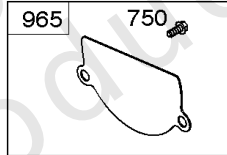
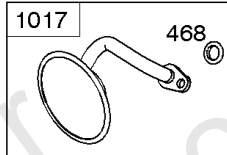
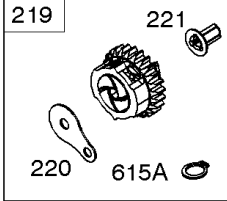

22

417A 417 1373 1155



1013

1013A

1027

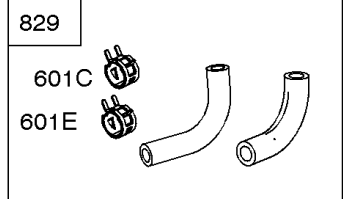
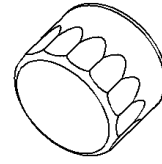

829

601C
601E

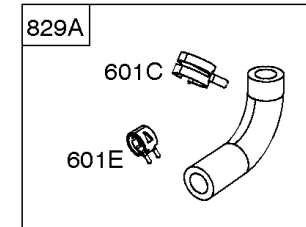

829A

601C
601E

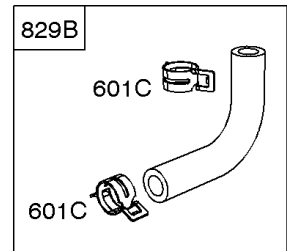

829B

601C
601C

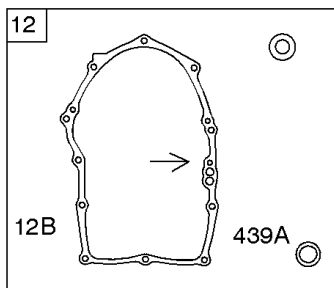

12

12B

439A

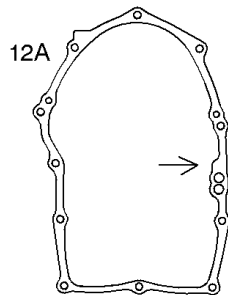

12A

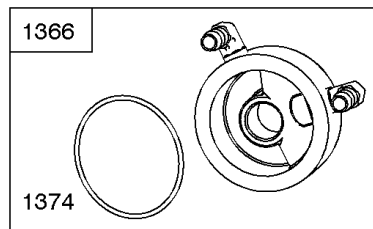

1366

1374

Crankcase Cover, Oil Cooler, Camshaft

| REF NO | PART NO | QTY | DESCRIPTION |
|--------|---------|-----|---|
| 12 | 846037 | | GASKET, Crankcase -Used After Code Date 13072100 |
| 12A | 844107 | | GASKET, Crankcase -Used Before Code Date 13072200 |
| 12B | 843969 | | GASKET, Crankcase -Used After Code Date 13072100 |
| 18 | 844792 | | COVER, Crankcase |
| 20 | 841596 | | SEAL, Oil -(PTO Side) |
| 22 | 807362 | | SCREW -(Crankcase Cover/Sump) (M8x50mm) |
| 45 | 809785 | | TAPPET, Valve |
| 46 | 809879 | | CAMSHAFT |
| 219 | 809426 | | GEAR, Governor |
| 220 | 841608 | | WASHER -(Governor Gear) |
| 221 | 841026 | | CUP, Governor |
| 273 | 690681 | | SEAL, O-Ring -(Oil Pump) |
| 417 | 841233 | | SCREW -(Oil Cooler) (M6x10mm) -Used After Code Date 14072600 |
| 417A | 843345 | | SCREW -(Oil Cooler) (M6x8mm) -Used Before Code Date 14072700 |
| 417B | 846250 | | SCREW -(Oil Cooler) (M6x16mm) -Used After Code Date 14052200 |
| 439 | 692154 | | O-RING, Oil Gallery -(Crankcase Cover/Sump or Cylinder Assembly) |
| 439A | 846027 | | O-RING, Oil Gallery -(Crankcase Cover/Sump or Cylinder Assembly) -Used After Code Date 13072100 |
| 468 | 690690 | | SEAL, O-Ring -(Oil Pump Screen) |
| 479 | 807084 | | SCREW -(Oil Pump Screen) |
| 523 | 841007 | | DIPSTICK |
| 596 | 691492 | | SCREW -(Oil Pump) |
| 601C | 841597 | | CLAMP, Hose -(Oil Cooler Hose) |
| 601E | 845209 | | CLAMP, Hose -(Oil Cooler Hose) |
| 615A | 698290 | | RETAINER, Governor Shaft -(Governor Gear) |
| 750 | 841233 | | SCREW -(Oil Pump Cover) |
| 829 | 846155 | | HOSE, Oil Cooler |
| 829A | 846247 | | HOSE, Oil Cooler -Used After Code Date 14052200 |
| 829B | 846248 | | HOSE, Oil Cooler -Used After Code Date 14052200 |
| 965 | 809422 | | COVER, Oil Pump |
| 1013 | 809505 | | NIPPLE, Oil Filter |
| 1013A | 841602 | | NIPPLE, Oil Filter |
| 1017 | 809421 | | SCREEN, Oil Pump |
| 1024 | 845983 | | PUMP, Oil |

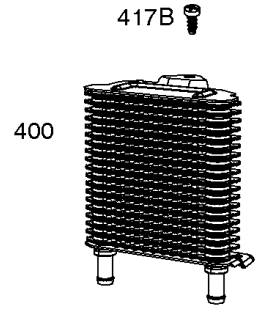
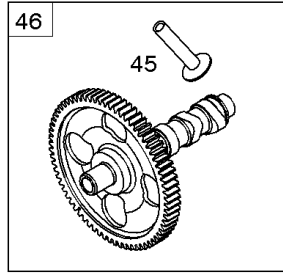
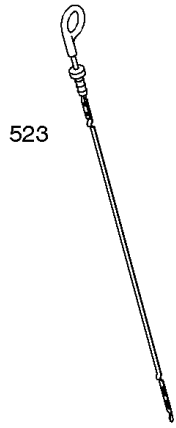

417B

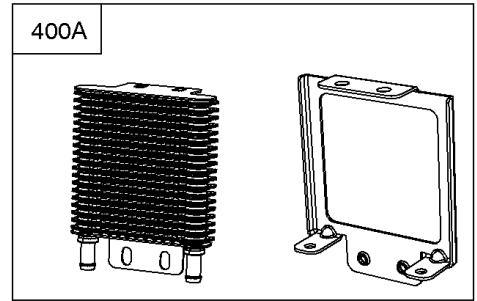

400A

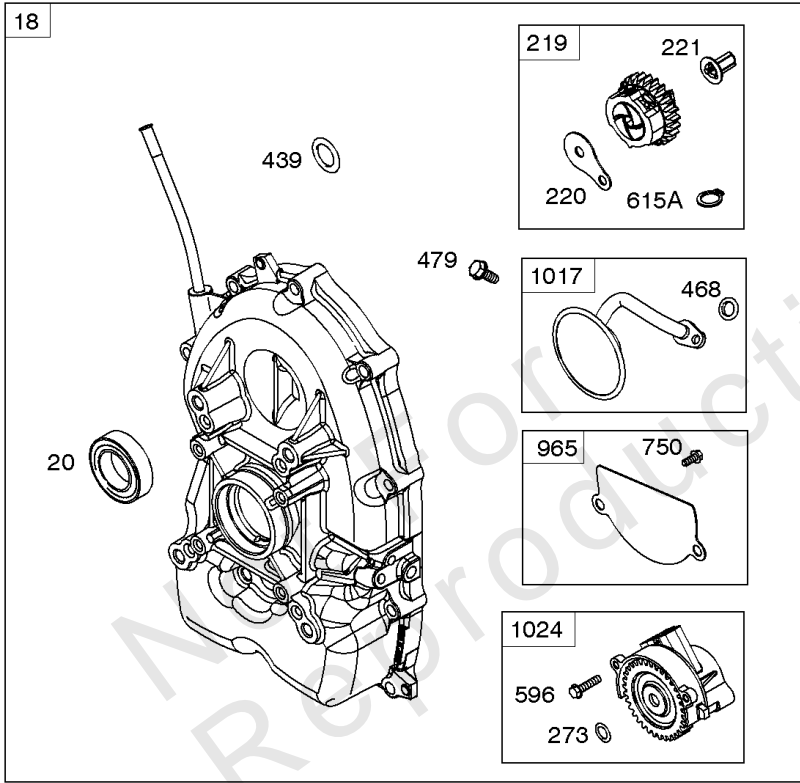

18

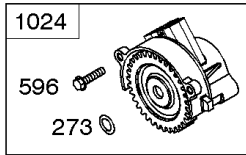
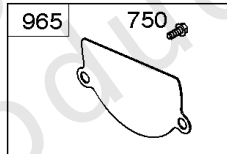
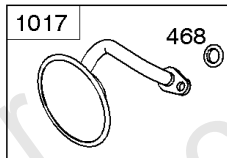
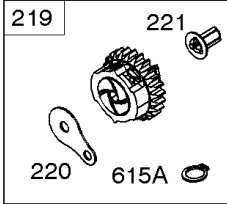

22

417A 417 1373 1155

1013 1013A

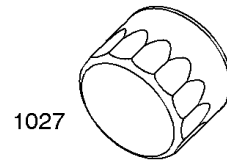

1027

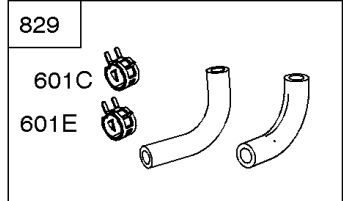

829

601C 601E

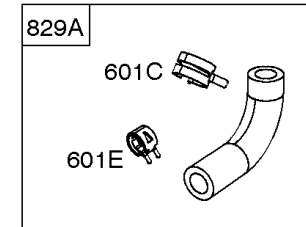

829A

601C 601E

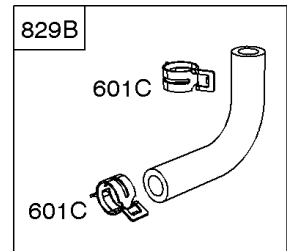

829B

601C 601C

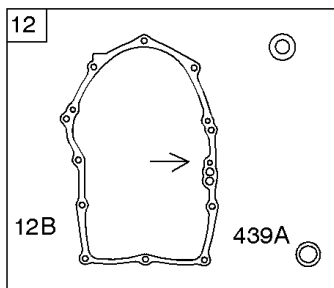

12

12B

439A

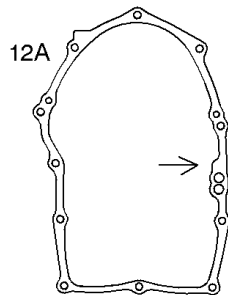

12A

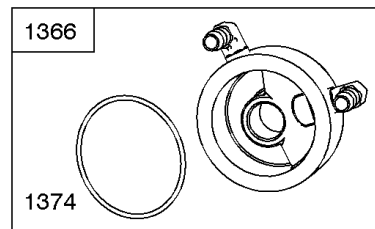

1366

1374

Crankcase Cover, Oil Cooler, Camshaft

| REF NO | PART NO | QTY | DESCRIPTION |
|--------|---------|-----|--|
| 1027 | 842921 | | FILTER, Oil |
| 1155 | 806647 | | WASHER -(Oil Cooler) -Used Before Code Date 13072700 |
| 1366 | 841510 | | DIVERTER, Oil Cooler |
| 1373 | 841233 | | SCREW -(Oil Cooler Bracket) |
| 1374 | 841506 | | SEAL, O-Ring -(Oil Cooler Diverter) |

Not For Reproduction

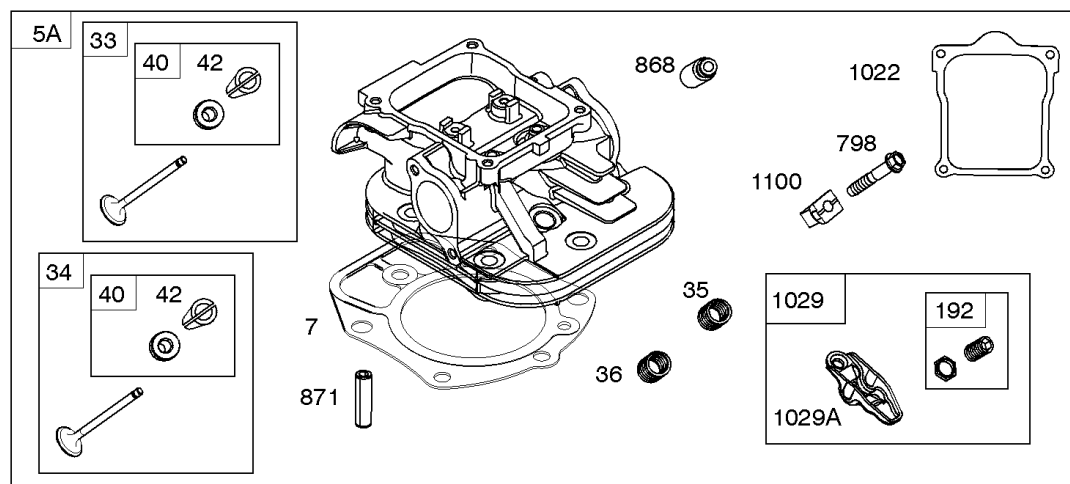
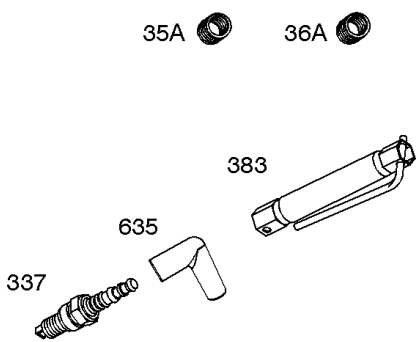
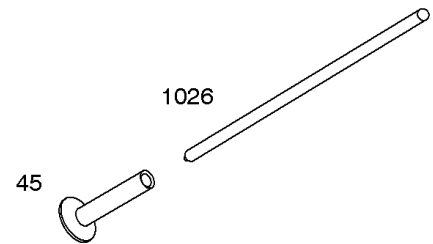
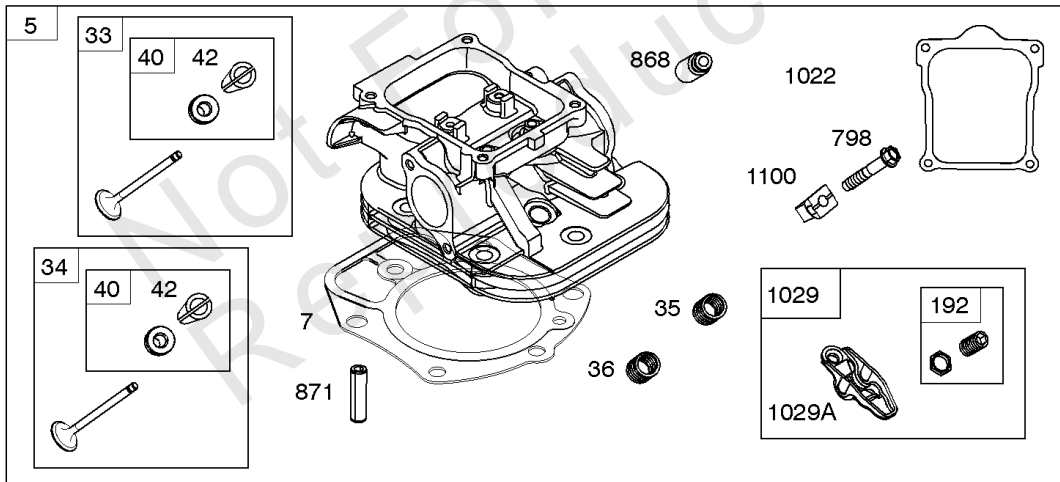
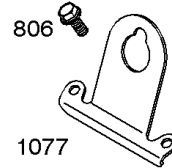
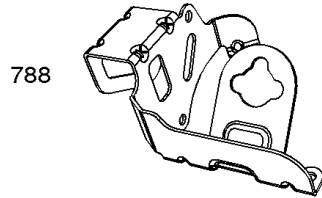
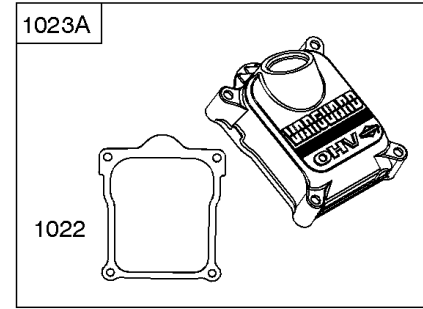
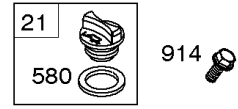
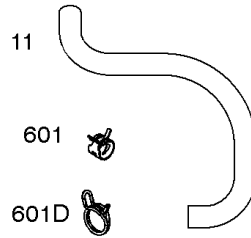
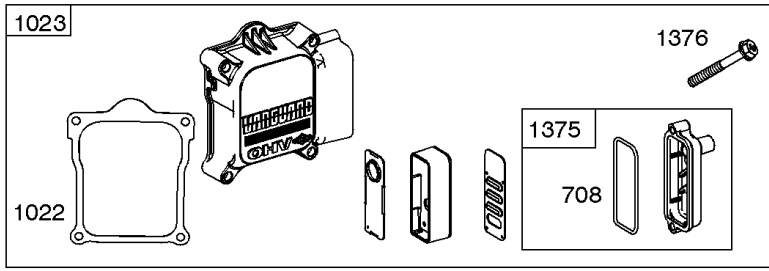

Cylinder Heads, Rocker Covers

| REF NO | PART NO | QTY | DESCRIPTION |
|--------|---------|-----|--|
| 5 | 845588 | | HEAD, Cylinder -(Cylinder 1) |
| 5A | 845590 | | HEAD, Cylinder -(Cylinder 2) |
| 7 | 809730 | | GASKET, Cylinder Head |
| 11 | 809736 | | TUBE, Breather |
| 13 | 809784 | | SCREW -(Cylinder Head) |
| 21 | 843464 | | CAP, Oil Fill |
| 33 | 844787 | | VALVE, Exhaust |
| 34 | 843730 | | VALVE, Intake |
| 35 | 845589 | | SPRING, Valve -(Intake) (Intake) (Pink) |
| 35A | 809374 | | SPRING, Valve -(Intake) (Intake) (White) |
| 36 | 845589 | | SPRING, Valve -(Exhaust) (Exhaust) (Pink) |
| 36A | 809374 | | SPRING, Valve -(Exhaust) (Exhaust) (White) |
| 40 | 844788 | | RETAINER, Valve |
| 42 | 807683 | | KEEPER, Valve |
| 45 | 809785 | | TAPPET, Valve |
| 192 | 690083 | | ADJUSTER, Rocker Arm |
| 337 | 792015 | | PLUG, Spark |
| 383 | 19576S | | WRENCH, Spark Plug |
| 580 | 809894 | | SEAL, O-Ring -(Oil Fill Cap) |
| 601 | 844405 | | CLAMP, Hose -(Breather Tube) -Used After Code Date 07121300 |
| 601D | 841499 | | CLAMP, Hose -(Breather Tube) -Used Before Code Date 07121400 |
| 635 | 692076 | | BOOT, Spark Plug |
| 708 | 841301 | | SEAL, O-Ring -(Breather Reed) |
| 788 | 844528 | | BRACKET, Fuel Pump |
| 798 | 691492 | | SCREW -(Rocker Arm) |
| 806 | 807357 | | SCREW -(Lifting Bracket) |
| 868 | 691963 | | SEAL, Valve |
| 871 | 692057 | | BUSHING, Valve Guide |
| 914 | 807357 | | SCREW -(Rocker Cover) |
| 1022 | 809732 | | GASKET, Rocker Cover |
| 1023 | 809789 | | COVER, Rocker -(Cylinder #2) |
| 1023A | 809731 | | COVER, Rocker -(Cylinder #1) |
| 1026 | 809783 | | ROD, Push -(Intake and Exhaust) |
| 1029 | 690972 | | ARM, Rocker |
| 1029A | 807323 | | ARM, Rocker |
| 1077 | 809729 | | BRACKET, Lifting |
| 1100 | 791959 | | PIVOT, Rocker Arm |
| 1375 | 841550 | | COVER, Breather Reed |

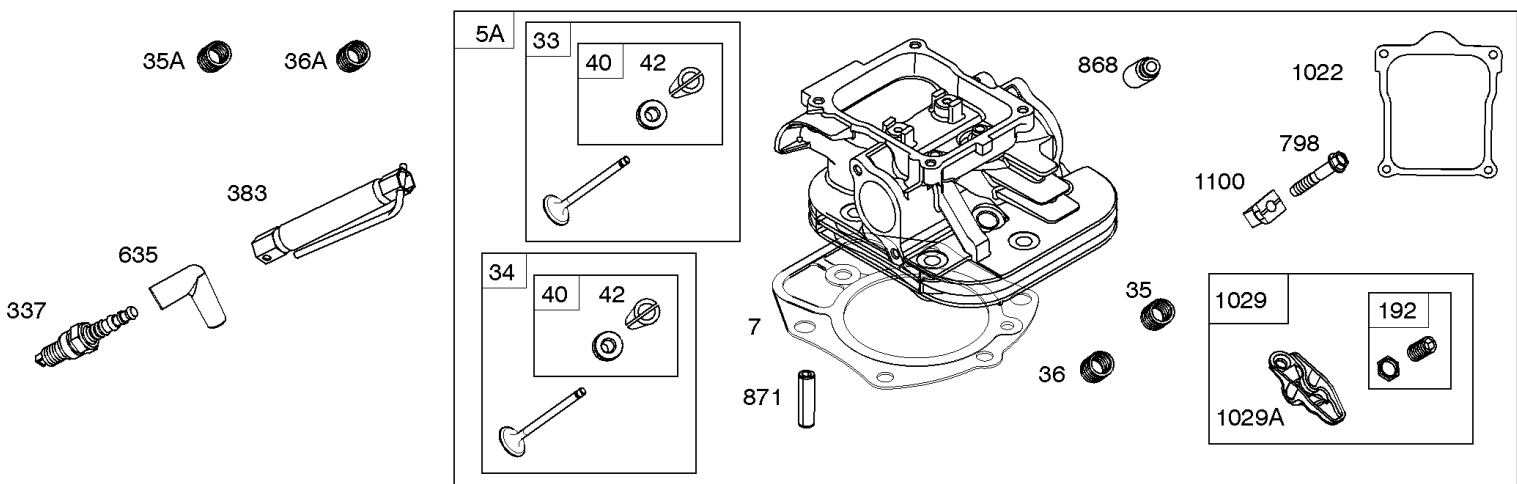
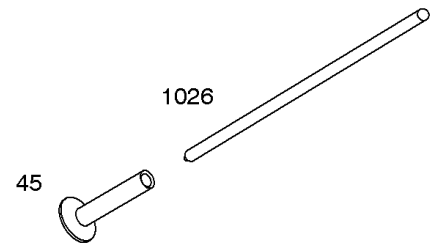
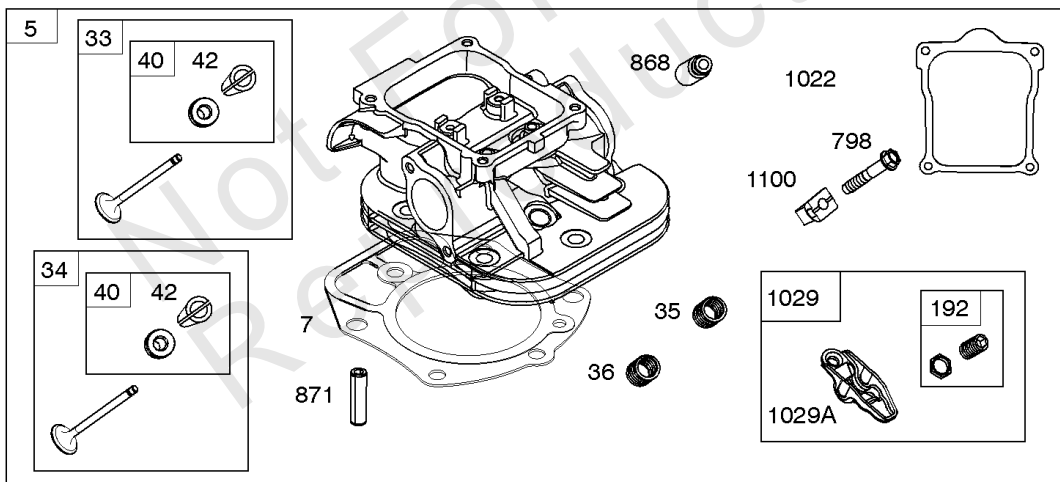
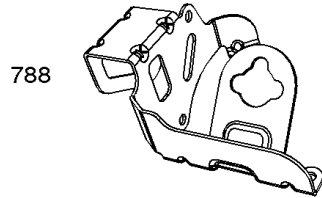
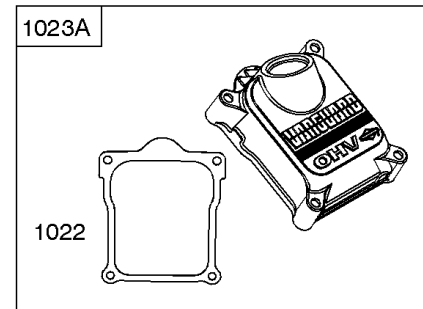
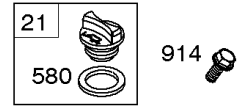
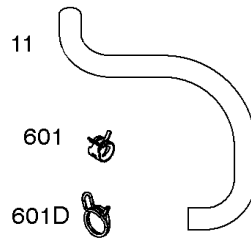
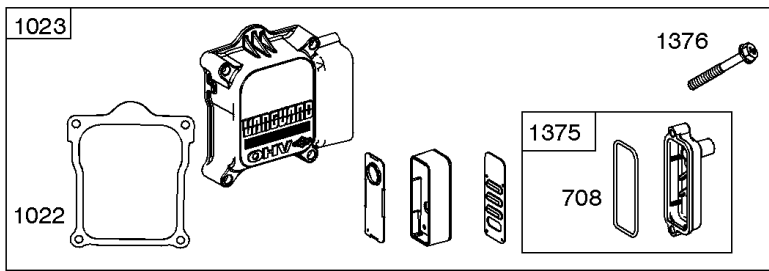

Cylinder Heads, Rocker Covers

| REF NO | PART NO | QTY | DESCRIPTION |
|--------|---------|-----|---------------------------------|
| 1376 | 806421 | | SCREW -(Breather Reed Cover) |

Not For Reproduction

Cylinder, Piston/Rings/Connecting Rod, Crankshaft

Mfg. No: 541477-1112-J1

1036

1319

1330

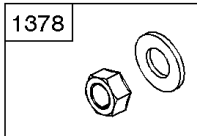
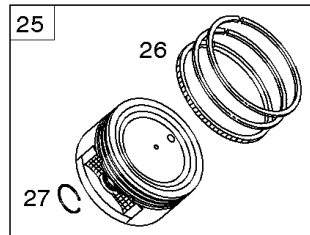
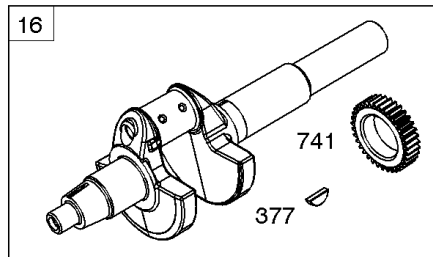
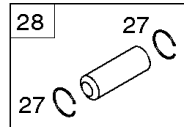
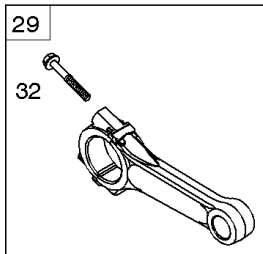
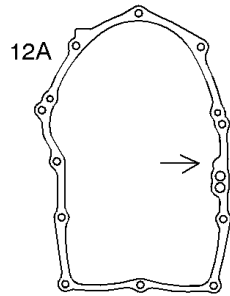
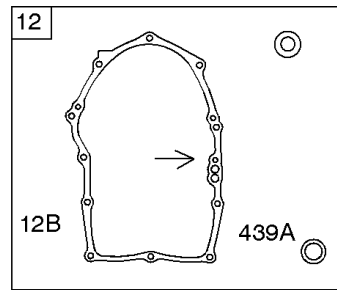
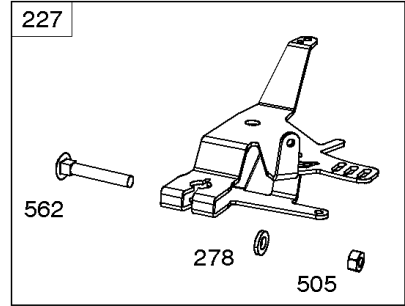
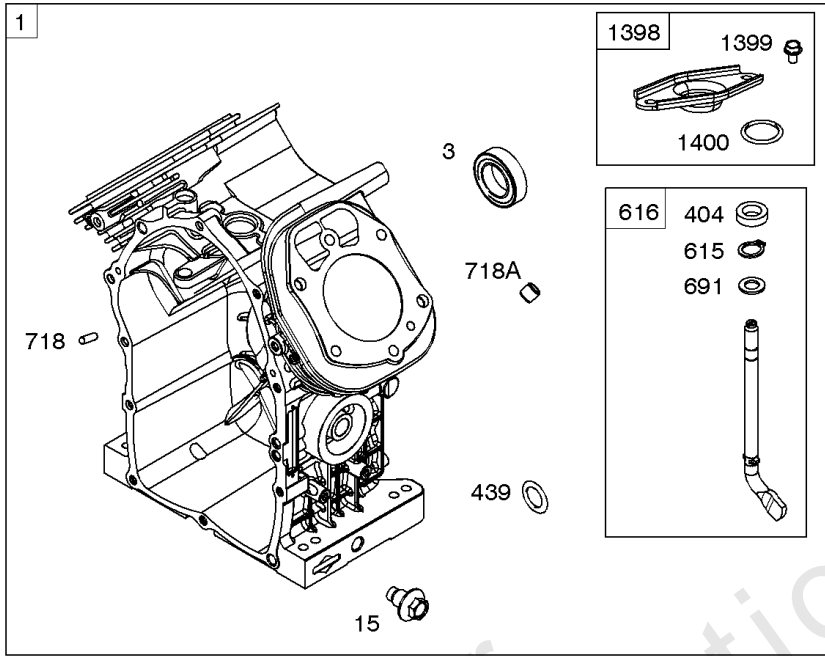
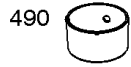

Cylinder, Piston/Rings/Connecting Rod, Crankshaft

| REF NO | PART NO | QTY | DESCRIPTION |
|--------|---------|-----|---|
| 1 | 845756 | | CYLINDER ASSEMBLY |
| 3 | 841596 | | SEAL, Oil -(Magneto Side) |
| 12 | 846037 | | GASKET, Crankcase -Used After Code Date 13072100 |
| 12A | 844107 | | GASKET, Crankcase -Used Before Code Date 13072200 |
| 12B | 843969 | | GASKET, Crankcase -Used After Code Date 13072100 |
| 15 | 807392 | | PLUG, Oil Drain |
| 16 | 843290 | | CRANKSHAFT |
| 24 | 796335 | | KEY, Flywheel -(Steel) -Used After Code Date 07122700 |
| 24 | 222698S | | KEY, Flywheel -(Aluminum) -Used Before Code Date 07122800 |
| 25 | 809790 | | PISTON ASSEMBLY -(Standard) |
| 25 | 841931 | | PISTON ASSEMBLY -(.020 Oversize) |
| 26 | 809972 | | SET, Ring -(Standard) |
| 26 | 841932 | | SET, Ring -(.020 Oversize) |
| 27 | 807351 | | LOCK, Piston Pin |
| 28 | 807361 | | PIN, Piston |
| 29 | 809275 | | ROD, Connecting |
| 32 | 807363 | | SCREW -(Connecting Rod) |
| 227 | 809984 | | LEVER, Governor Control |
| 239 | 841281 | | SWITCH, Oil Pressure |
| 278 | 842122 | | WASHER -(Governor Control Lever) |
| 377 | 691639 | | KEY, Woodruff |
| 404 | 809436 | | WASHER -(Governor Crank) |
| 439 | 692154 | | O-RING, Oil Gallery -(Crankcase Cover/Sump or Cylinder Assembly) |
| 439A | 846027 | | O-RING, Oil Gallery -(Crankcase Cover/Sump or Cylinder Assembly) -Used After Code Date 13072100 |
| 490 | 843433 | | BEARING, Magneto Side |
| 505 | 844752 | | NUT -(Governor Control Lever) |
| 562 | 843344 | | BOLT -(Governor Lever) |
| 615 | 809533 | | RETAINER, Governor Shaft -(Governor Shaft) |
| 616 | 844180 | | CRANK, Governor |
| 691 | 809287 | | SEAL, Governor Shaft |
| 718 | 690959 | | PIN, Locating -(Cylinder) |
| 718A | 809508 | | PIN, Locating -(Cylinder Head) |
| 741 | 809432 | | GEAR, Timing |
| 1013 | 809505 | | NIPPLE, Oil Filter |
| 1013A | 841602 | | NIPPLE, Oil Filter |

Cylinder, Piston/Rings/Connecting Rod, Crankshaft

Mfg. No: 541477-1112-J1

1036

1319

1330

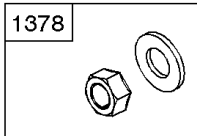
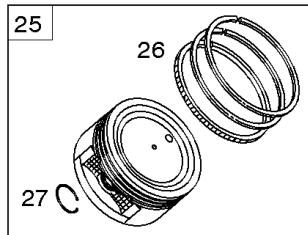
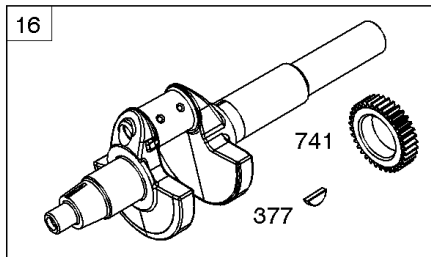
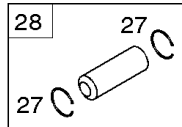
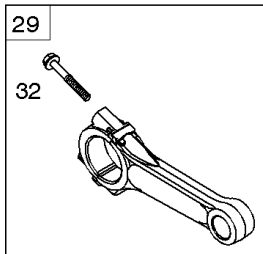
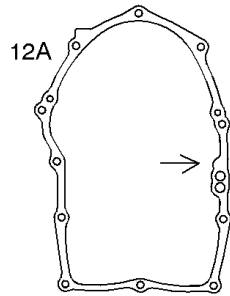
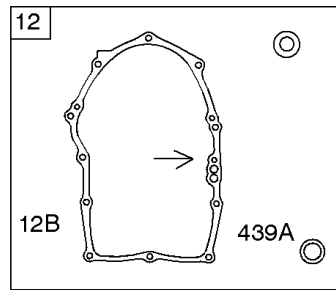
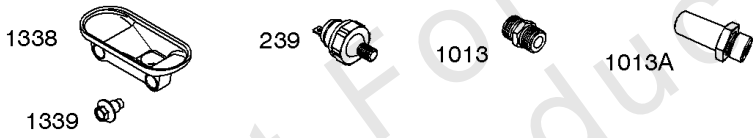
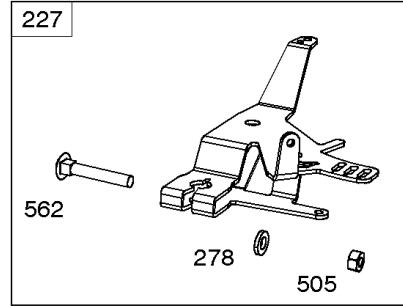
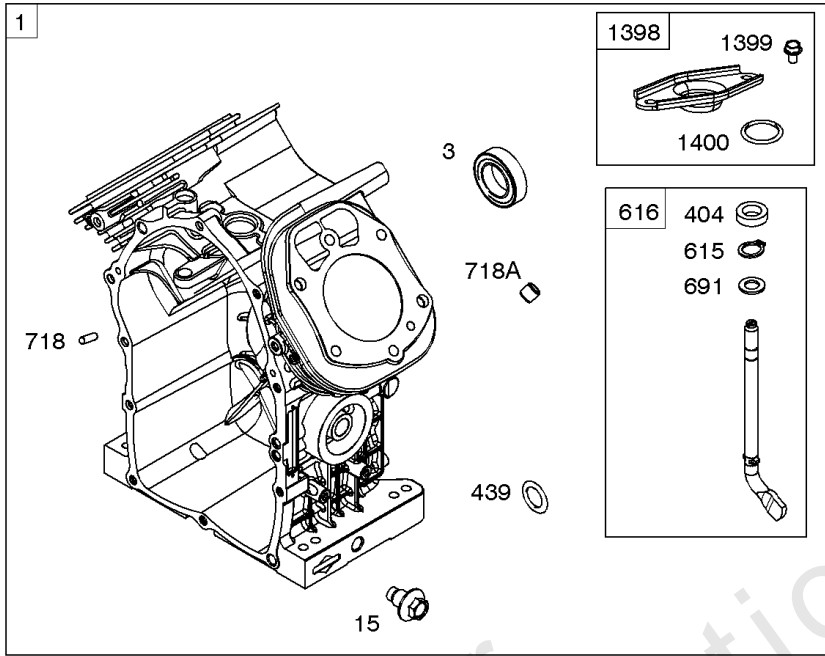
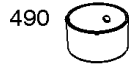

Cylinder, Piston/Rings/Connecting Rod, Crankshaft

| REF NO | PART NO | QTY | DESCRIPTION |
|--------|---------|-----|---|
| 1027 | 842921 | | FILTER, Oil |
| 1036 | ----- | | LABEL, Emissions -(Available From A Briggs & Stratton Authorized Dealer) |
| 1319 | 794467 | | LABEL, Warning |
| 1330 | 272144 | | MANUAL, Repair |
| 1338 | 809334 | | TRAY, Oil Drip |
| 1339 | 807435 | | SCREW -(Oil Drip Tray) |
| 1398 | 842191 | | COVER, Fuel Pump |
| 1399 | 690932 | | SCREW -(Fuel Pump Cover) |
| 1400 | 809894 | | SEAL, O-Ring -(Fuel Pump Cover) |

Not For Reproduction

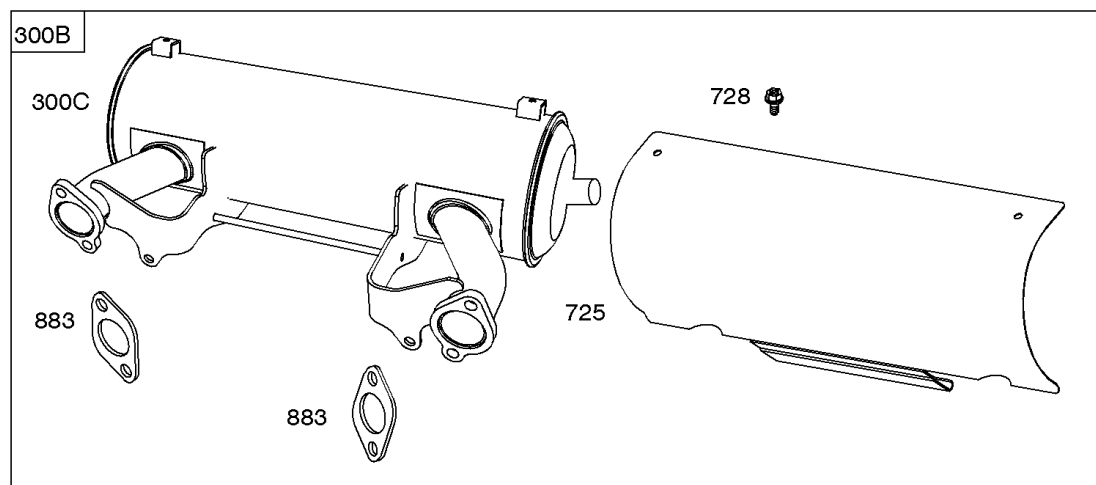
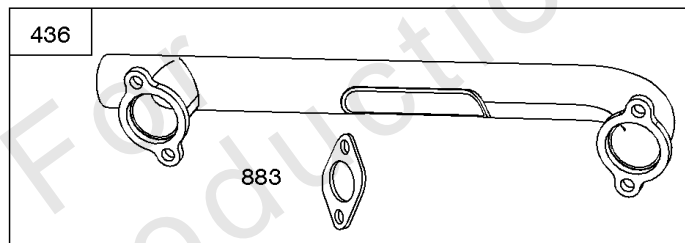
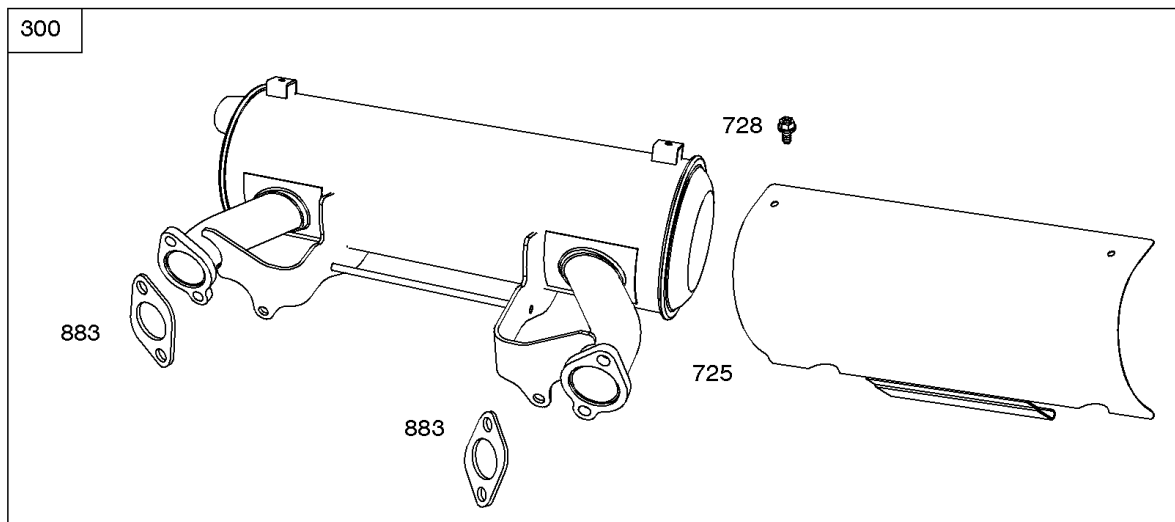

Exhaust System

| REF NO | PART NO | QTY | DESCRIPTION |
|--------|---------|-----|--|
| 437 | 809743 | | SCREW -(Exhaust Manifold) (M8x18mm) |
| 613 | 692062 | | SCREW -(Muffler) (M8x25mm) |
| 725 | 841132 | | SHIELD, Heat |
| 728 | 692067 | | SCREW -(Heat Shield) |
| 883 | 809872 | | GASKET, Exhaust |

Not For Reproduction

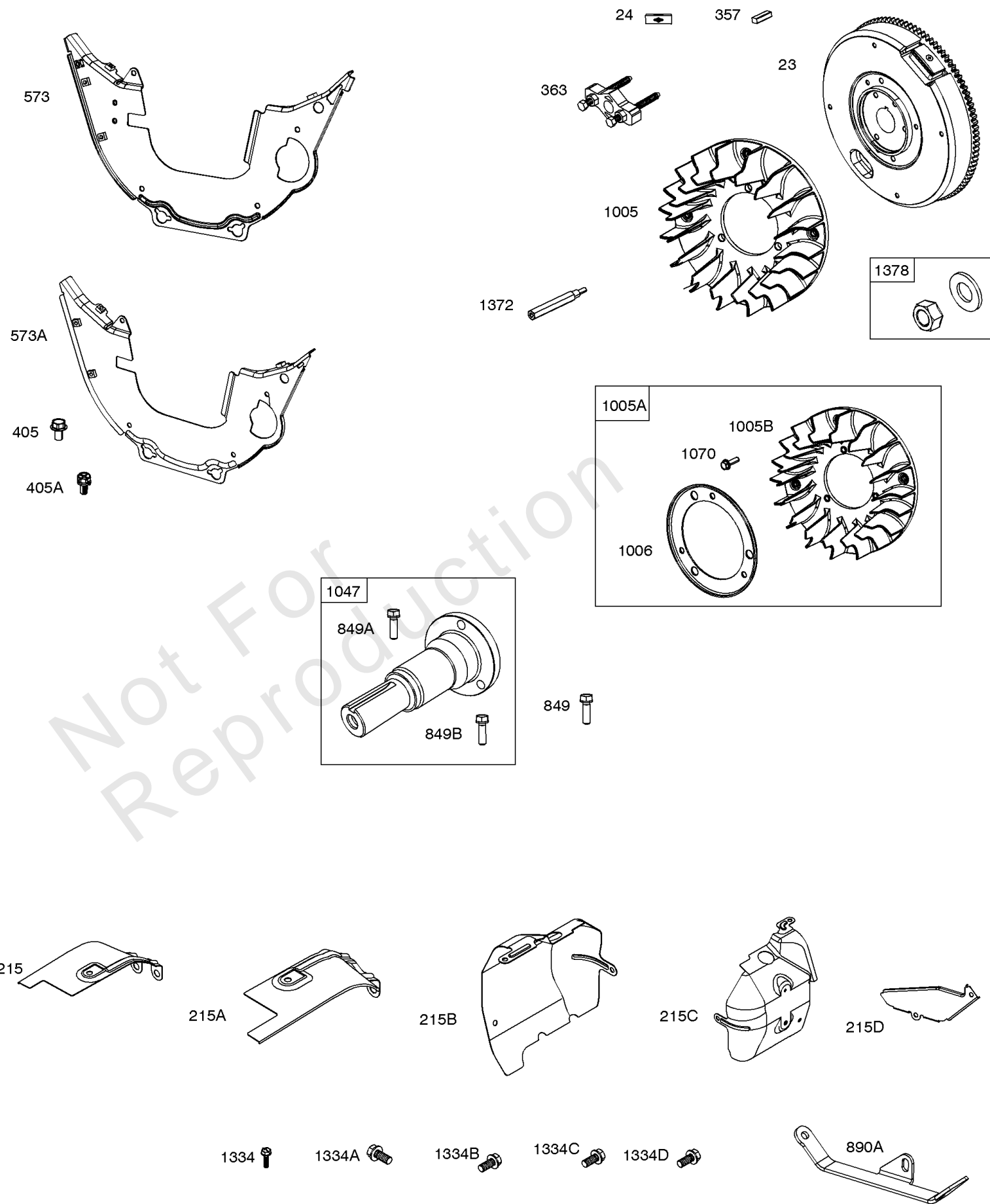

Flywheel, Air Guides, Stub Shaft

| REF NO | PART NO | QTY | DESCRIPTION |
|--------|---------|-----|---|
| 23 | 844385 | | FLYWHEEL |
| 24 | 222698S | | KEY, Flywheel -(Aluminum) -Used Before Code Date 07122800 |
| 24 | 796335 | | KEY, Flywheel -(Steel) -Used After Code Date 07122700 |
| 215 | 809728 | | GUIDE, Air -(Cylinder 1) |
| 215A | 809737 | | GUIDE, Air -(Cylinder 2) |
| 215B | 809897 | | GUIDE, Air -(Cylinder #2) |
| 215C | 809738 | | GUIDE, Air -(Cylinder #1) |
| 215D | 809739 | | GUIDE, Air -(Valley) |
| 363 | 19203 | | PULLER, Flywheel |
| 405 | 841233 | | SCREW -(Back Plate) (M6x10mm) |
| 405A | 841735 | | SCREW -(Back Plate) (M6x14mm) -Used After Code Date 14121500 |
| 573A | 846840 | | PLATE, Back |
| 849 | 846236 | | SCREW -(Stub Shaft) (M8x34mm) -Used After Code Date 14112600 |
| 849A | 691088 | | SCREW -(Stub Shaft) (5/16-18x1.1) -Used Before Code Date 14112700 |
| 849B | 846235 | | SCREW -(Stub Shaft) (M8x28mm) -Used After Code Date 14112600 |
| 890A | 841614 | | BRACKET, Support |
| 1005 | 846996 | | FAN, Flywheel -Used After Code Date 15080600 |
| 1005A | 847199 | | FAN, Flywheel -Used Before Code Date 15080700 |
| 1005B | 846995 | | FAN, Flywheel -Used After Code Date 15080600 |
| 1006 | 847198 | | RETAINER, Fan |
| 1070 | 807435 | | SCREW -(Flywheel Fan) |
| 1334 | 807435 | | SCREW -(Air Guide) (M6x20mm) |
| 1334A | 841233 | | SCREW -(Air Guide) (M6x10mm) |
| 1334C | 690677 | | SCREW -(Air Guide) (M4x12mm) |
| 1334B | 692062 | | SCREW -(Air Guide) (M8x18mm) |
| 1334D | 807084 | | SCREW -(Air Guide) (M6x14mm) |
| 1372 | 809946 | | STUD -(Rotating Screen) |

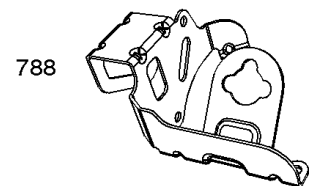
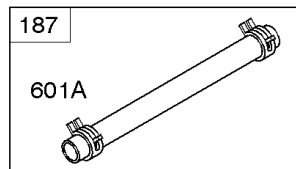
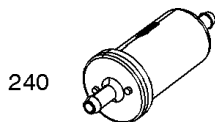
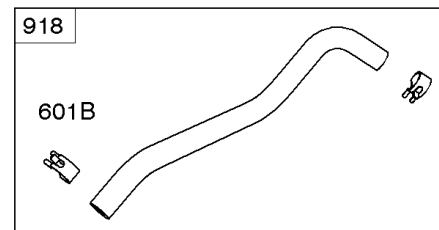
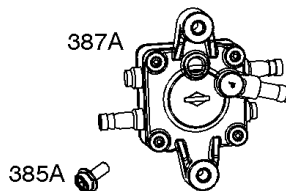
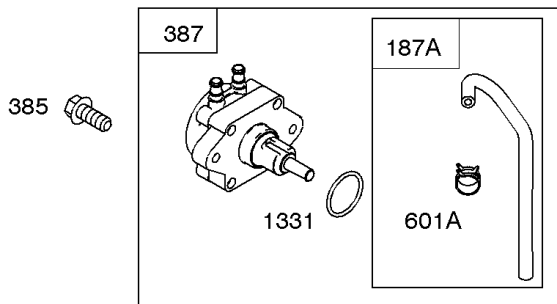
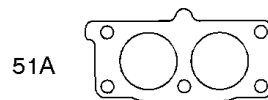
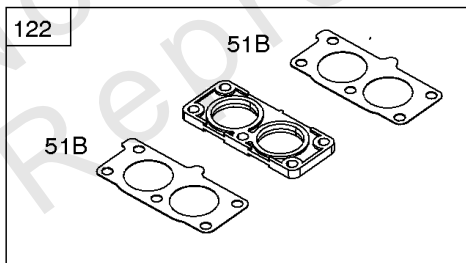
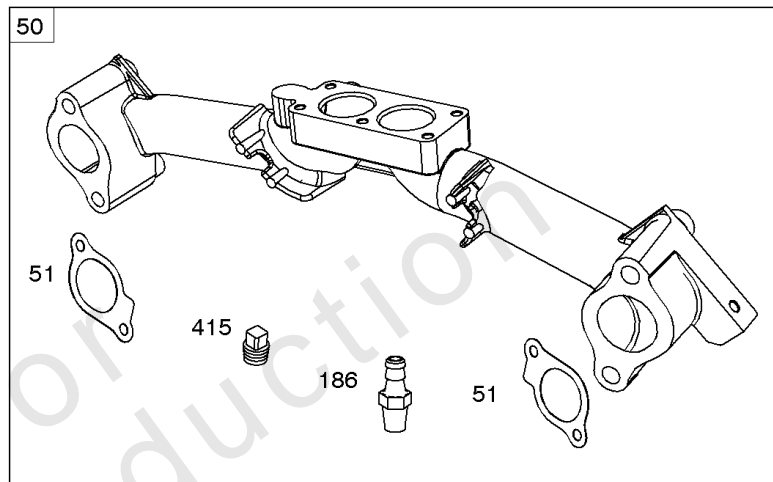
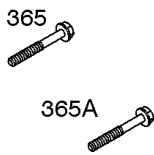
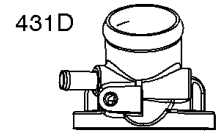
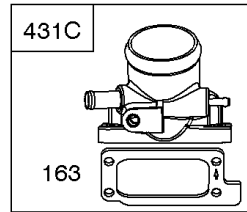
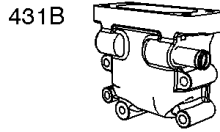
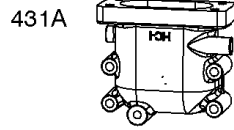
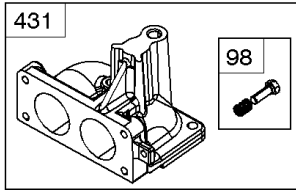

Intake Manifold, Intake Elbows, Fuel Supply

| REF NO | PART NO | QTY | DESCRIPTION |
|--------|---------|-----|---|
| 50 | 844340 | | MANIFOLD, Intake |
| 51 | 841592 | | GASKET, Intake |
| 51A | 809910 | | GASKET, Intake |
| 51B | 841882 | | GASKET, Intake |
| 54 | 844656 | | SCREW -(Intake Manifold) (M8x72mm) -Used After Code Date 10092900 |
| 98 | 841842 | | KIT, Idle Speed -(Intake Elbow) |
| 122 | 846245 | | SPACER, Carburetor |
| 163 | 807375 | | GASKET, Air Cleaner |
| 186 | 844568 | | CONNECTOR, Hose -(Intake Manifold) (Without Sealant Patch) |
| 186 | 691764 | | CONNECTOR-HOSE -(Intake Manifold) (Sealant Patch) |
| 187 | 791745 | | LINE, Fuel -(23 Inches)(Cut To Required Length) |
| 187 | 791766 | | LINE, Fuel -(15 Inches Long)(Cut to Required Length) |
| 187A | 844081 | | LINE, Fuel -(Formed Hose) |
| 240 | 845125 | | FILTER, Fuel |
| 290 | 809911 | | SCREW -(Intake Elbow) (M6x55mm) |
| 290A | 807421 | | SCREW -(Intake Elbow) (M6x25mm) |
| 365 | 807437 | | SCREW -(Carburetor/Throttle Body) (M6x85mm) |
| 365A | 841853 | | SCREW -(Carburetor/Throttle Body) (M6x103mm) |
| 385 | 809876 | | SCREW -(Fuel Pump) (M5x22mm) |
| 385A | 807084 | | SCREW -(Fuel Pump) (M6x14mm) |
| 387 | 844086 | | PUMP, Fuel |
| 387A | 844527 | | PUMP, Fuel |
| 415 | 794903 | | PLUG |
| 431 | 841539 | | ELBOW, Intake |
| 431A | 843116 | | ELBOW, Intake -Used After Code Date 06062200 |
| 431D | 809896 | | ELBOW, Intake |
| 431C | 845920 | | ELBOW, Intake |
| 601A | 791850 | | CLAMP, Hose -(Green) |
| 601B | 691038 | | CLAMP, Hose -(Black) |
| 788 | 844528 | | BRACKET, Fuel Pump |
| 918 | 844525 | | HOSE, Vacuum |
| 1130 | 841590 | | STUD -(Intake Manifold) -Used Before Code Date 10093000 |
| 1174 | 842067 | | NUT -(Intake Manifold) -Used Before Code Date 10093000 |
| 1331 | 809894 | | SEAL, O-Ring -(Fuel Pump) (Fuel Pump) |

Replacement Engine - US & Canada

| REF NO | PART NO | QTY | DESCRIPTION |
|--------|---------|-----|-------------|
|--------|---------|-----|-------------|

Not For Reproduction

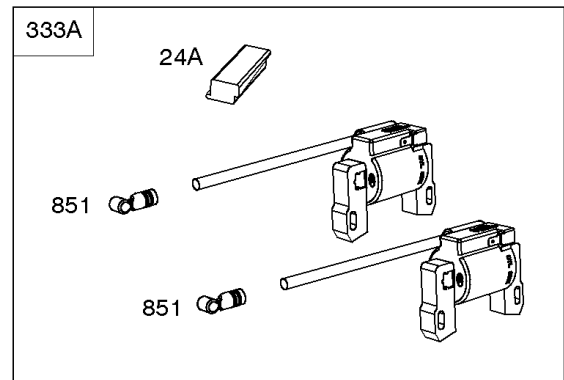
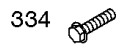
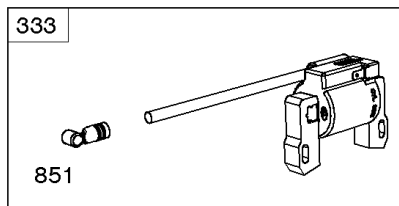
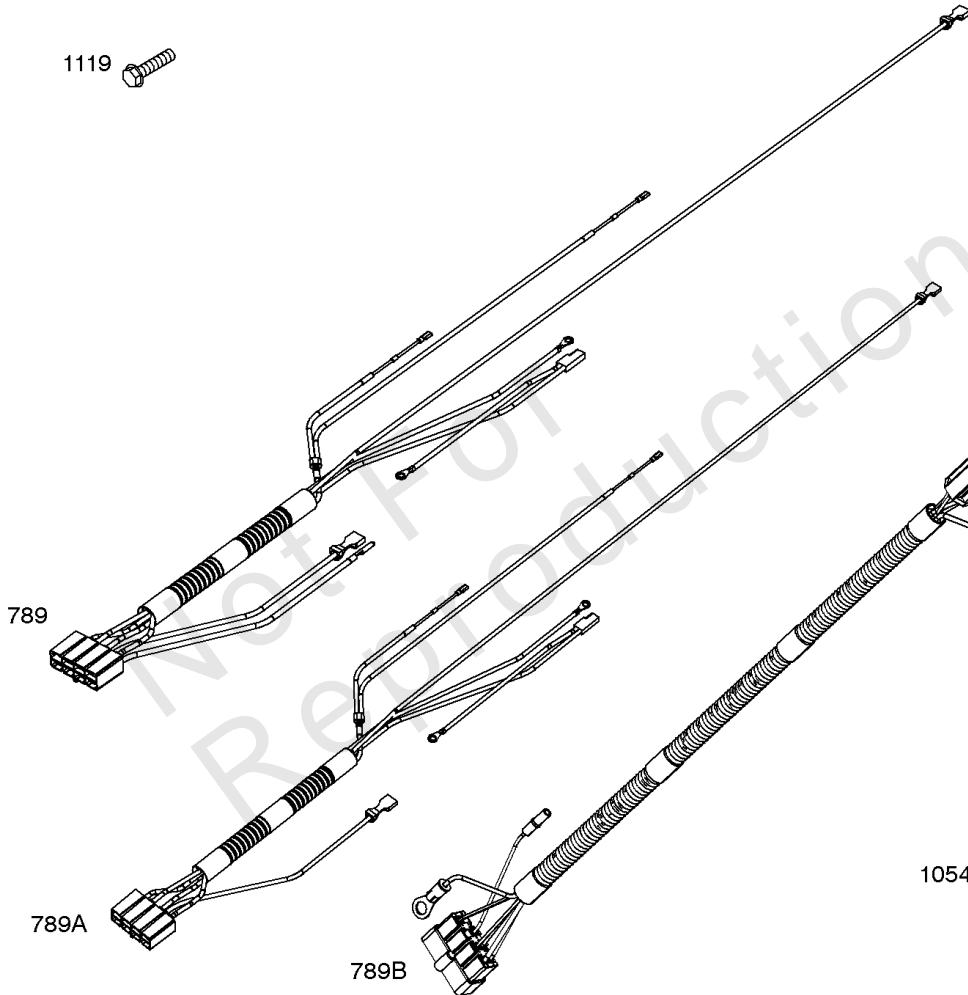
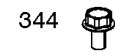
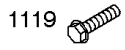
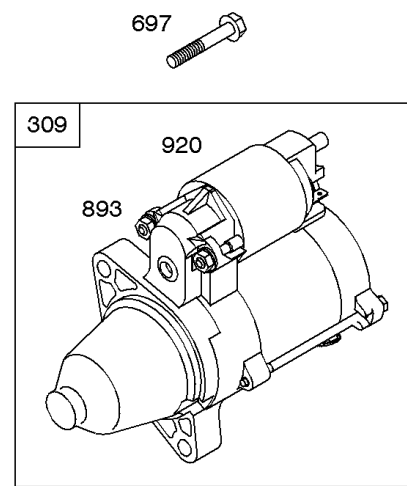
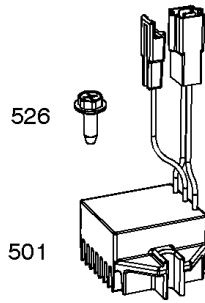
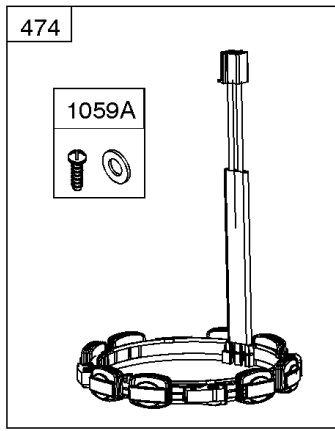

Starter Motor, Wire Harness's, Armatures

| REF NO | PART NO | QTY | DESCRIPTION |
|--------|---------|-----|---|
| 24A | 843837 | | KEY, Flywheel -(Offset Key) (Aluminum) |
| 309 | 845760 | | MOTOR, Starter |
| 333 | 845126 | | ARMATURE, Magneto -Used After Code Date 06111400 |
| 333A | 843860 | | ARMATURE, Magneto -(Includes Offset Flywheel Key) -Used Before Code Date 06111500 |
| 334 | 692066 | | SCREW -(Magneto Armature) |
| 344 | 841233 | | SCREW -(Cable Clamp) (M6x10mm) |
| 474 | 846882 | | ALTERNATOR |
| 501 | 593843 | | REGULATOR |
| 526 | 690717 | | SCREW -(Regulator) |
| 527 | 690423 | | CLAMP, Tube |
| 578 | 847202 | | WIRE ASSEMBLY -(Wire Harness to Regulator) (Red) |
| 578A | 846899 | | WIRE ASSEMBLY -(Regulator to Starter Motor) -Used After Code Date 15110100 |
| 587 | 846866 | | CLAMP, Cable |
| 587A | 807116 | | CLAMP, Tube |
| 635 | 692076 | | BOOT, Spark Plug |
| 697 | 690711 | | SCREW -(Starter Motor) (Drive Cap) (M8x38mm) |
| 789 | 847060 | | HARNESS, Wiring -Used After Code Date 15110100 |
| 789A | 809906 | | HARNESS, Wiring -Used Before Code Date 15110200 |
| 789B | 809967 | | HARNESS, Wiring |
| 851 | 493880S | | TERMINAL-SPARK PLUG |
| 893 | 845758 | | NUT -(Starter Solenoid) |
| 920 | 845757 | | SOLENOID, Starter -Used Before Code Date 12070100 |
| 920 | 846737 | | SOLENOID, Starter -Used After Code Date 12063000 |
| 1054 | 280275 | | TIE, Cable |
| 1059A | 698516 | | KIT, Screw/Washer -(Alternator) |
| 1119 | 691552 | | SCREW -(Alternator) |
| 1336 | 841015 | | SHIELD, Wire Protective |



Model 54-61 Engine Accessories Catalog

Not For
Reproduction



Maintenance Kits

| REF NO | PART NO | QTY | DESCRIPTION |
|--------|----------|-----|--|
| 9000 | 84002318 | | KIT, Maintenance -(Oil Guard™ Engines) |
| 9000A | 84002315 | | KIT, Maintenance -(Non-Oil Guard™ Engines) |
| 9000B | 84004936 | | KIT, Maintenance -(Non-Oil Guard™ Engines) (20 - 40 HP) |
| 240 | 845125 | 1 | FILTER, Fuel |
| 337 | 491055S | 2 | PLUG, Spark |
| 445 | 841497 | 1 | FILTER, A/C Cartridge -"Professional / PXi" & "Commercial / CXi". |
| 445A | 692519 | 1 | FILTER, A/C Cartridge -"Professional / PXi" & "Commercial / CXi". |
| 967 | 692520 | 1 | FILTER, Pre Cleaner |
| 1027 | 595930 | 1 | FILTER, Oil -(Oil Guard™) |
| 1027A | 842921 | 1 | FILTER, Oil -(Vanguard®) |
| 1505 | 100170 | | OIL-5QT VANGUARD (CASE) -(5 qt Bottle) |
| 1505A | 100169 | | OIL-1QT VANGUARD (CASE) -(1 qt Bottle) |

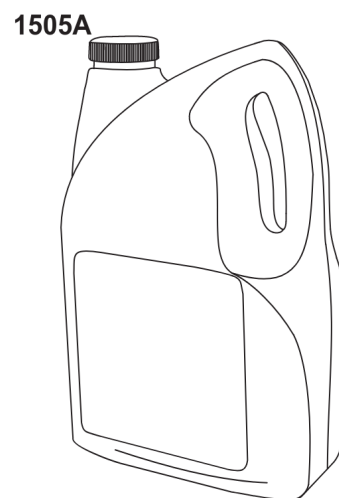
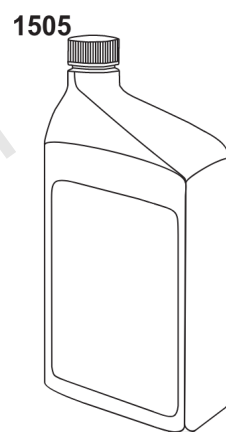
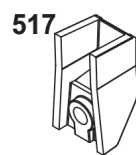
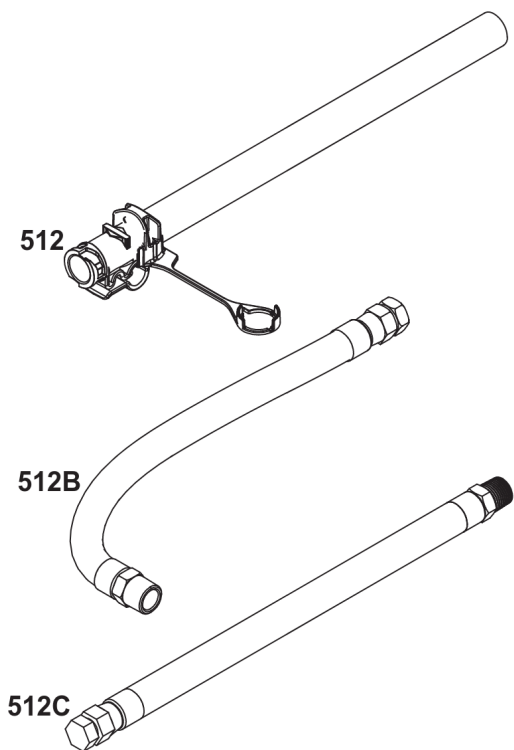

Not For
Reproduction

Lubrication

| REF NO | PART NO | QTY | DESCRIPTION |
|--------|-----------|-----|---|
| 186 | 796532 | 1 | CONNECTOR, Hose -(Threaded Engine Block Connector for EZ-Oil Drain Hose)(Order hose separate) |
| 239 | 690233 | 1 | SWITCH, Oil Pressure -(2-4 PSI Normally-Closed Switch) |
| 239A | 491657S | 1 | SWITCH, Oil Pressure -(3-5 PSI Normally-Closed Switch) |
| 239B | 841281 | 1 | SWITCH, Oil Pressure -(7-10 PSI Normally-Closed Switch) |
| 239C | 694115 | 1 | SWITCH, Oil Pressure -(9-13 PSI Normally-Closed Switch) |
| 239D | 697049 | 1 | SWITCH, Oil Pressure -(3-6 PSI Normally-Open Switch) |
| 460 | 1761386YP | 1 | CONNECTOR, Filter Adapter -(Oil Drain Valve) (Fitting M14, 90 Degree 9/16 JIC) |
| 460A | 5100366SM | 1 | METRIC ADAPTER, M14-1 -(Threaded engine block adapter M14 to 3/8 for EZ-Oil Drain connector) (order 796532 separate) |
| 512 | 594200 | 1 | HOSE, Oil Drain -(EZ-Oil Drain Hose, 10.5") (Order threaded engine block connector separate) |
| 512 | 593635 | 1 | HOSE, Oil Drain -(EZ-Oil Drain Hose, 13.75") (Order threaded engine block connector separate) |
| 512B | 1723165SM | 1 | HOSE, Oil Drain, 10-1/2" Long, 3/8-18 Fittings -(10.5") |
| 512C | 5048681SM | 1 | HOSE, OIL DRAIN -(12.5") |
| 517 | 593633 | 1 | RETAINER, Oil Drain |
| 1346 | 844802 | 1 | VALVE, Oil Drain Shut Off |
| 1346A | 492031 | 1 | VALVE, Oil Drain Shut Off |
| 1505 | 100169 | | OIL-1QT VANGUARD (CASE) -(1 qt. Bottle) |
| 1505A | 100170 | | OIL-5QT VANGUARD (CASE) -(5 qt. Bottle) |

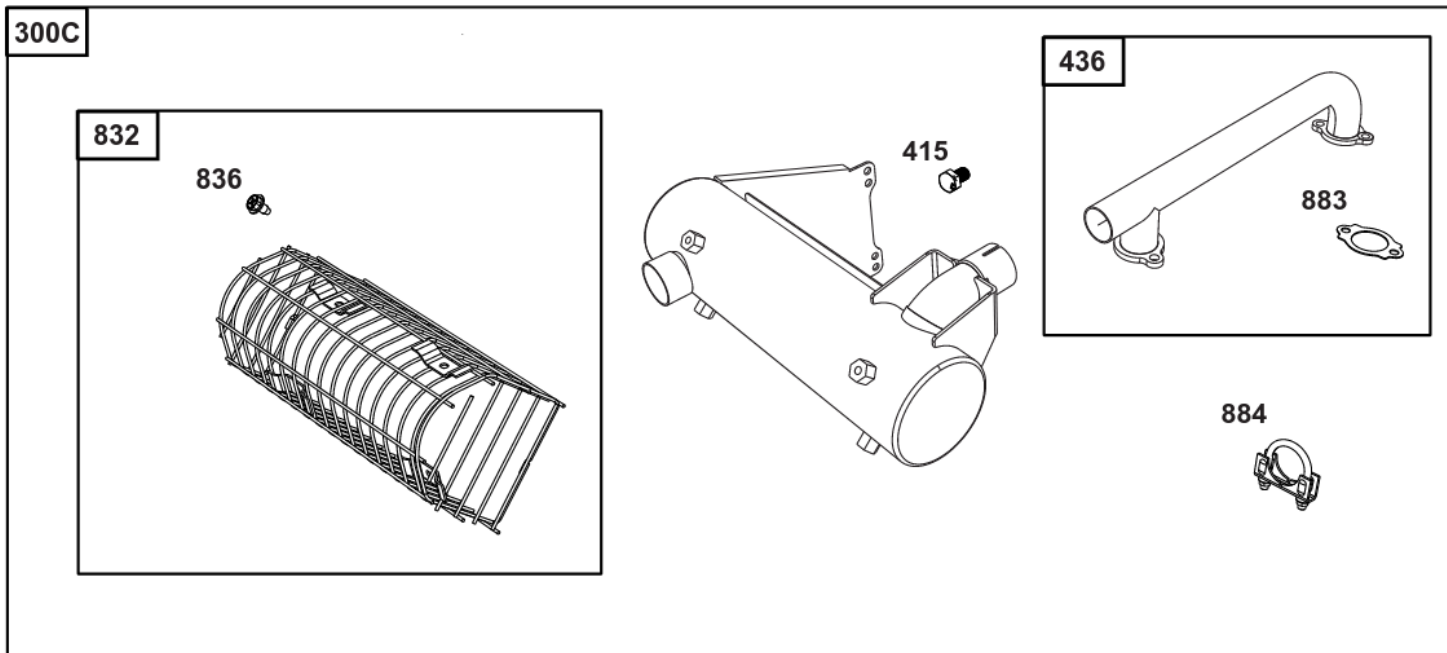
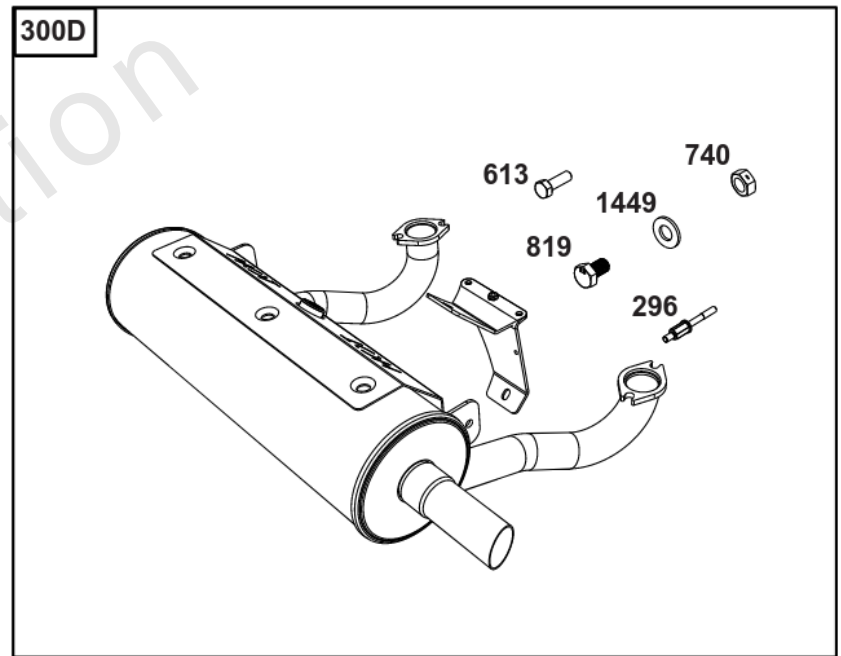
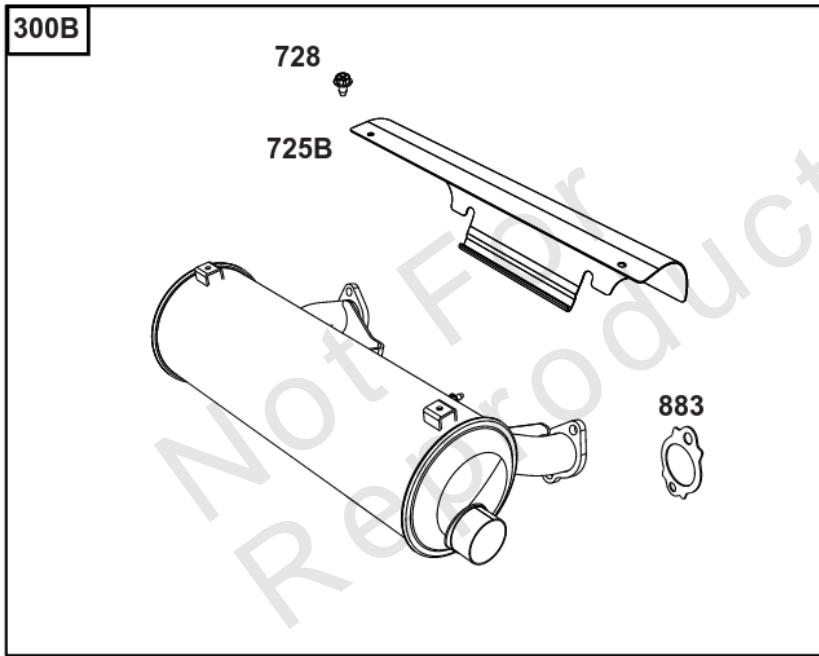
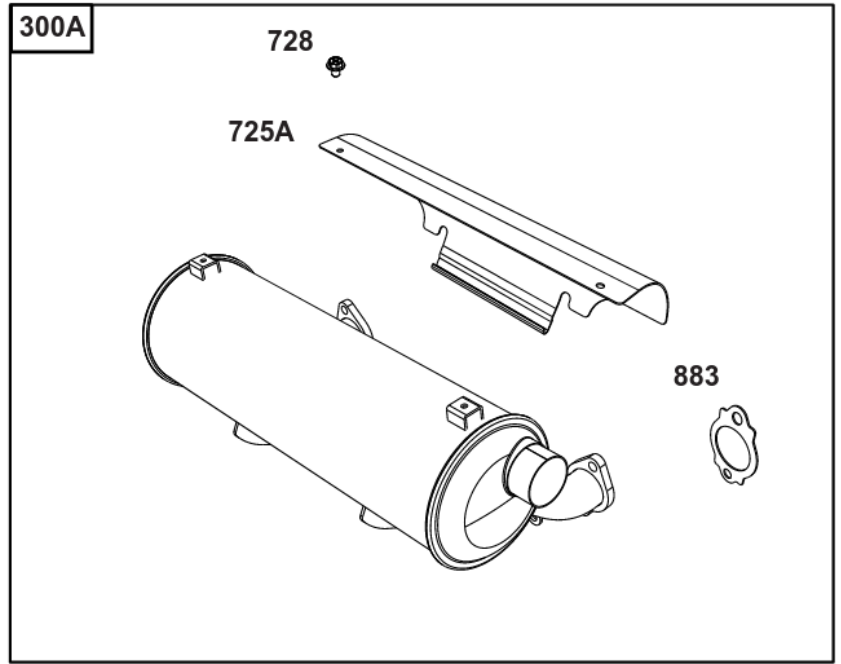
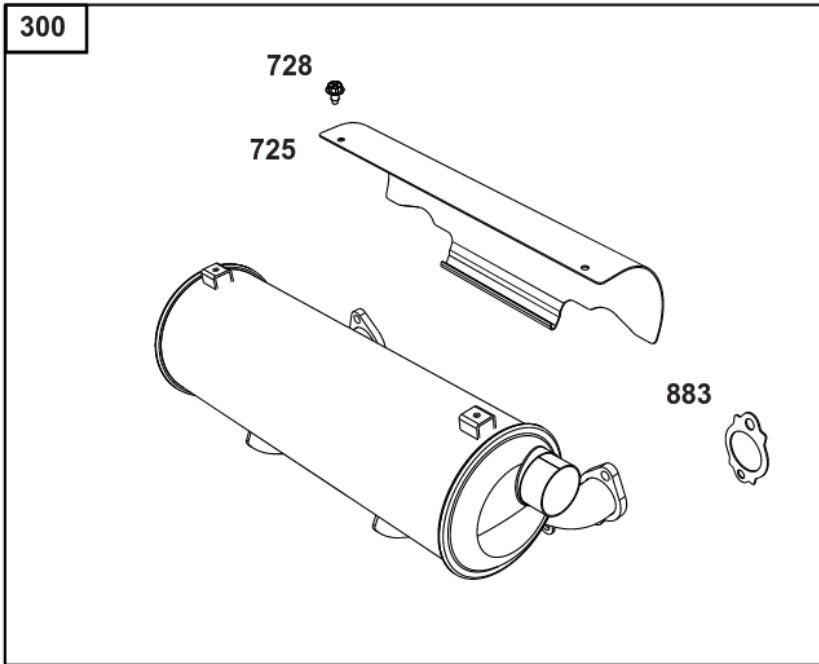

Oil Filter Side Outlet Mufflers

| REF NO | PART NO | QTY | DESCRIPTION |
|--------|-------------|-----|---|
| 296 | 844813 | 4 | STUD -(Muffler) |
| 300 | 846819 | 1 | MUFFLER -(High Mount) (Oil Filter Side Outlet) (EFI) |
| 300A | 846246 | 1 | MUFFLER -(Mid Mount) (Oil Filter Side Outlet) |
| 300B | 847486 | 1 | MUFFLER -(Mid Mount) (Oil Filter Side Outlet) (EFI) |
| 300C | 847278 | 1 | MUFFLER -(Side Mount) (Oil Filter Side Outlet) (EFI) |
| 300D | 84007299 | 1 | MUFFLER -(Vertical Shaft)(Oil Filter Side Outlet) |
| 415 | 596859 | 1 | PLUG |
| 436 | 841681 | 1 | MANIFOLD, Exhaust |
| 613 | 596859 | | PLUG -(Muffler) |
| 725 | 847229 | 1 | SHIELD, Heat |
| 725A | 844338 | 1 | SHIELD, Heat |
| 725B | 847487 | 1 | SHIELD, Heat |
| 728 | 692067 | 2 | SCREW -(Heat Shield) |
| 740 | 703164 | 2 | NUT -Muffler Bracket |
| 819 | 5025011X8SM | 2 | CAPSCREW, Hex Head, 5/16-18 X 1 -(Muffler Bracket) |
| 832 | 841682 | 1 | GUARD, Muffler |
| 836 | 841233 | 4 | SCREW -(Muffler Guard) |
| 883 | 809872 | 2 | GASKET, Exhaust |
| 884 | 841968 | 1 | CLAMP, Muffler |
| 1449 | 703350 | 4 | WASHER -(Muffler) |

Center Outlet Mufflers

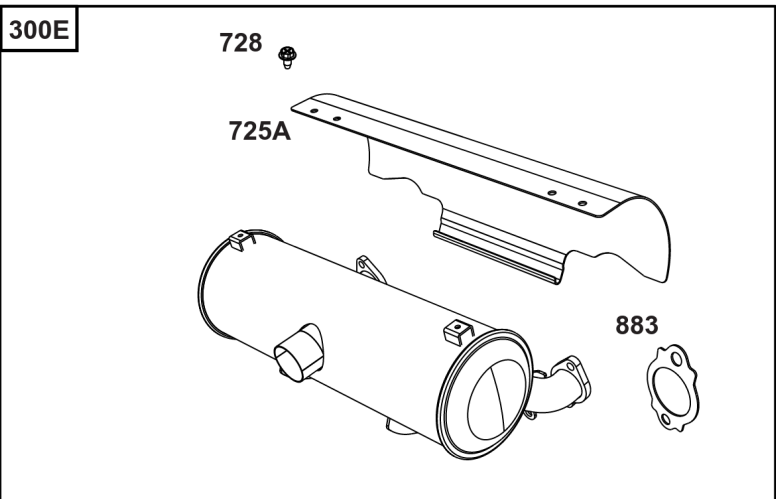
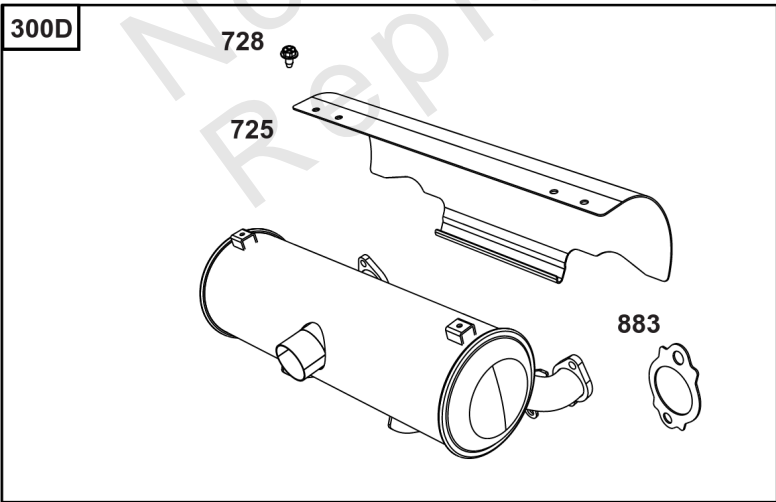
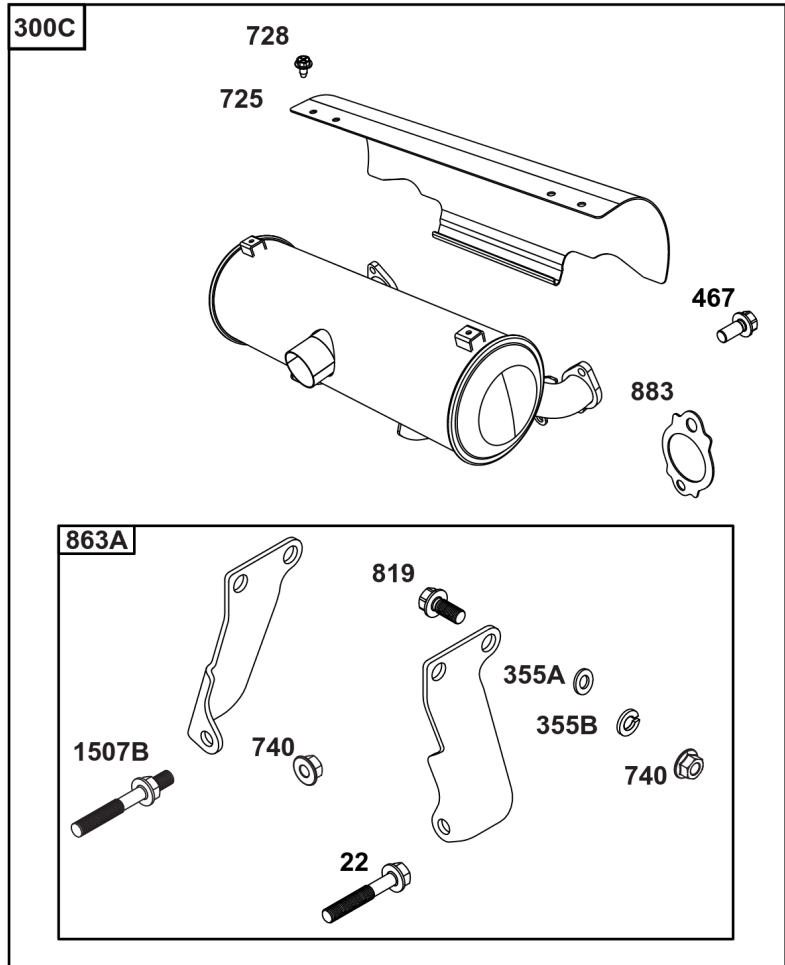
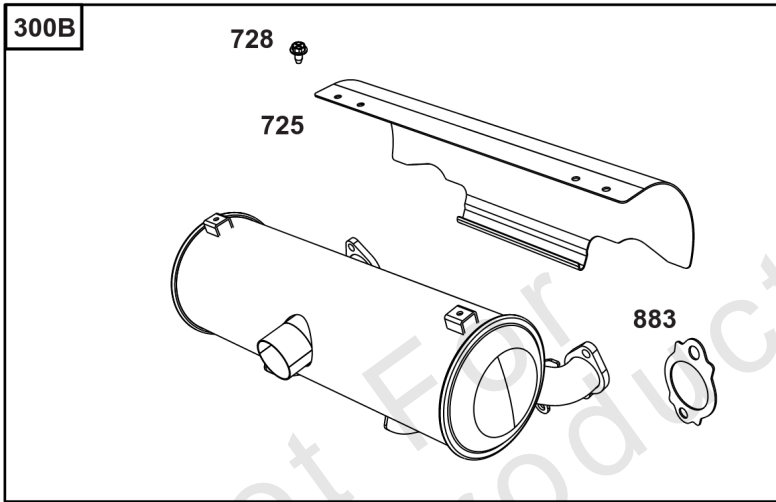
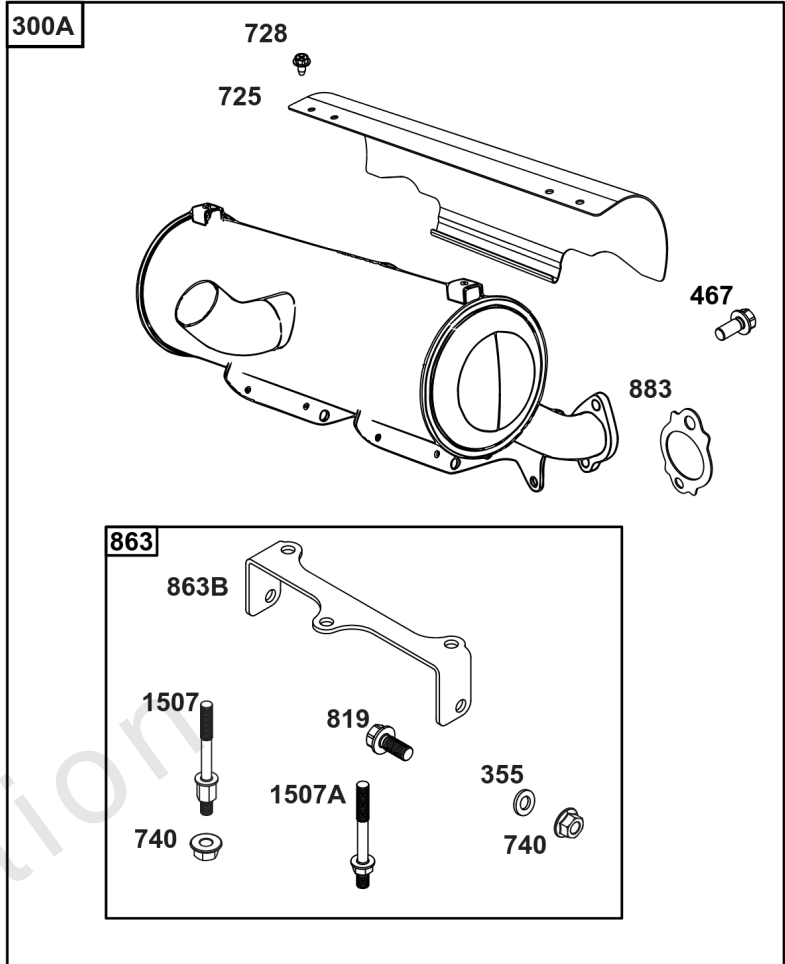
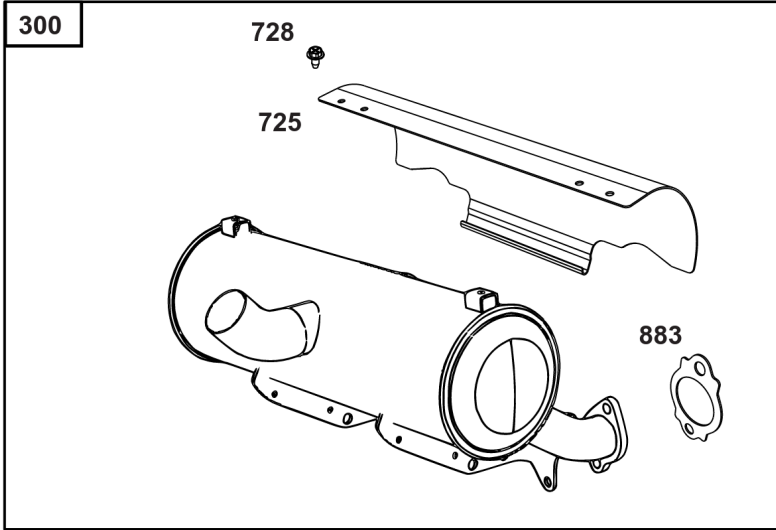

Center Outlet Mufflers

| REF NO | PART NO | QTY | DESCRIPTION |
|--------|---------|-----|--|
| 22 | 807362 | 2 | SCREW -(Muffler Bracket) |
| 300 | 846443 | 1 | MUFFLER -(Vertical Shaft) (Center Outlet) (304 Stainless Steel) |
| 300A | 847940 | 1 | MUFFLER -(Vertical Shaft) (Center Outlet) (304 Stainless Steel) (Performance Muffler for 40 HP) |
| 300B | 846154 | 1 | MUFFLER -(Horizontal Shaft) (High Mount) (Center Outlet) |
| 300C | 847922 | 1 | MUFFLER -(Horizontal Shaft) (High Mount) (Center Outlet) (304 Stainless Steel) (Performance Muffler for 40 HP) |
| 300D | 846444 | 1 | MUFFLER -(Horizontal Shaft) (High Mount) (Center Outlet) (304 Stainless Steel) |
| 300E | 847478 | 1 | MUFFLER -(Horizontal Shaft) (High Mount) (Center Outlet) (O2 Sensor Port) (EFI) |
| 355 | 844035 | 2 | WASHER -(Muffler Bracket) |
| 355A | 691261 | 2 | WASHER -(Muffler Bracket) |
| 355B | 691075 | 8 | WASHER -(Muffler Bracket) |
| 467 | 846149 | 4 | SCREW -(Exhaust Manifold) |
| 725 | 841132 | 1 | SHIELD, Heat |
| 725A | 847229 | 1 | SHIELD, Heat |
| 728 | 692067 | 2 | SCREW -(Heat Shield) |
| 740 | 690941 | 5 | NUT |
| 819 | 692062 | 2 | SCREW -(Muffler Bracket) |
| 863 | 848296 | 1 | BRACKET, Muffler |
| 863A | 843487 | 1 | BRACKET, Muffler |
| 863B | 848296 | 1 | BRACKET, Muffler |
| 883 | 809872 | 2 | GASKET, Exhaust |
| 1507 | 848297 | 1 | STUD -(Muffler Bracket) |
| 1507A | 848298 | 2 | STUD -(Muffler Bracket) |
| 1507B | 846324 | 2 | STUD -(Muffler Bracket) |

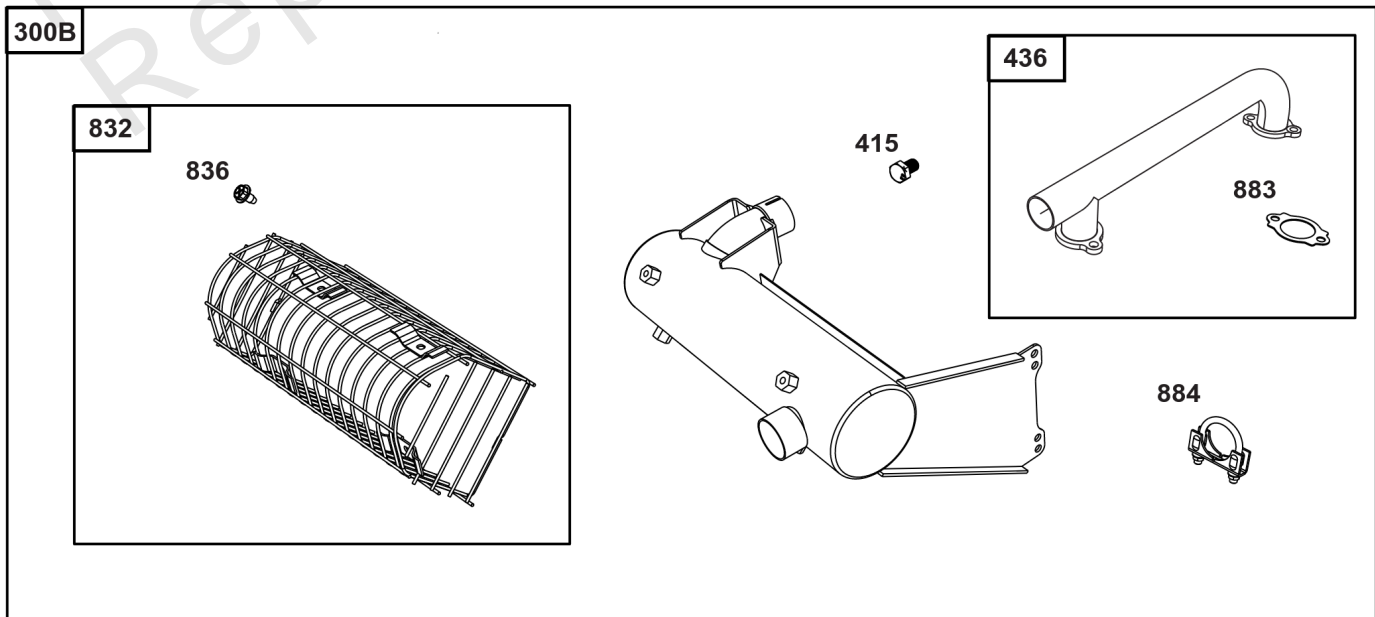
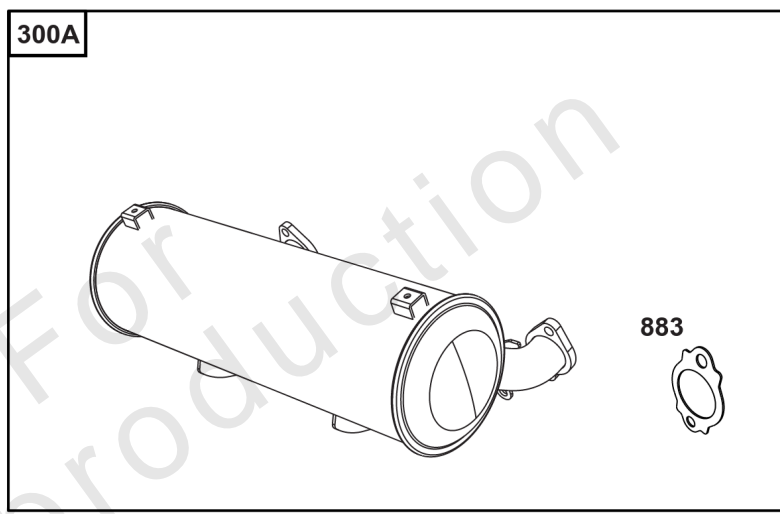
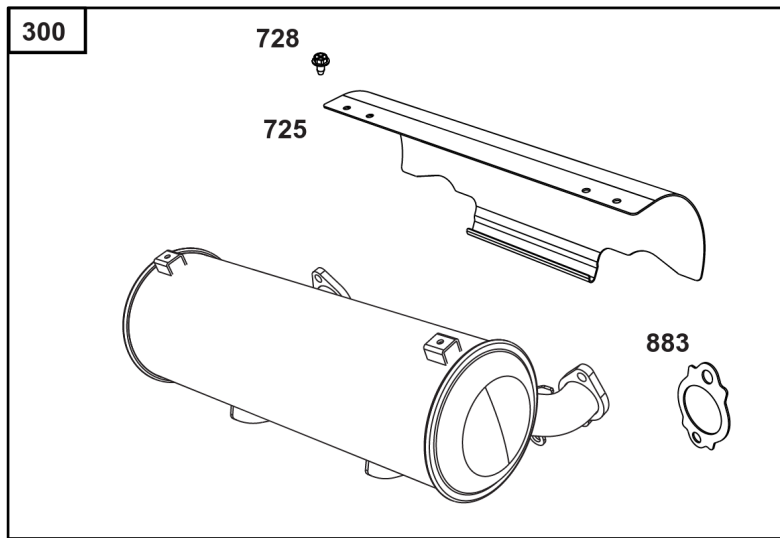

Starter Side Outlet Mufflers

| REF NO | PART NO | QTY | DESCRIPTION |
|--------|---------|-----|--|
| 300 | 845741 | 1 | MUFFLER -(High Mount) (Starter Side Outlet) |
| 300A | 847083 | 1 | MUFFLER -(Starter Side Outlet) (EFI) |
| 300B | 847279 | | MUFFLER -(Side Mount) (Starter Side Outlet) (EFI) |
| 415 | 596859 | 1 | PLUG |
| 436 | 842263 | 1 | MANIFOLD, Exhaust |
| 725 | 841132 | 1 | SHIELD, Heat |
| 728 | 692067 | 2 | SCREW -(Heat Shield) |
| 832 | 841682 | 1 | GUARD, Muffler |
| 836 | 841233 | 4 | SCREW -(Muffler Guard) |
| 883 | 809872 | 2 | GASKET, Exhaust |
| 884 | 841968 | 1 | CLAMP, Muffler |

Not For Reproduction

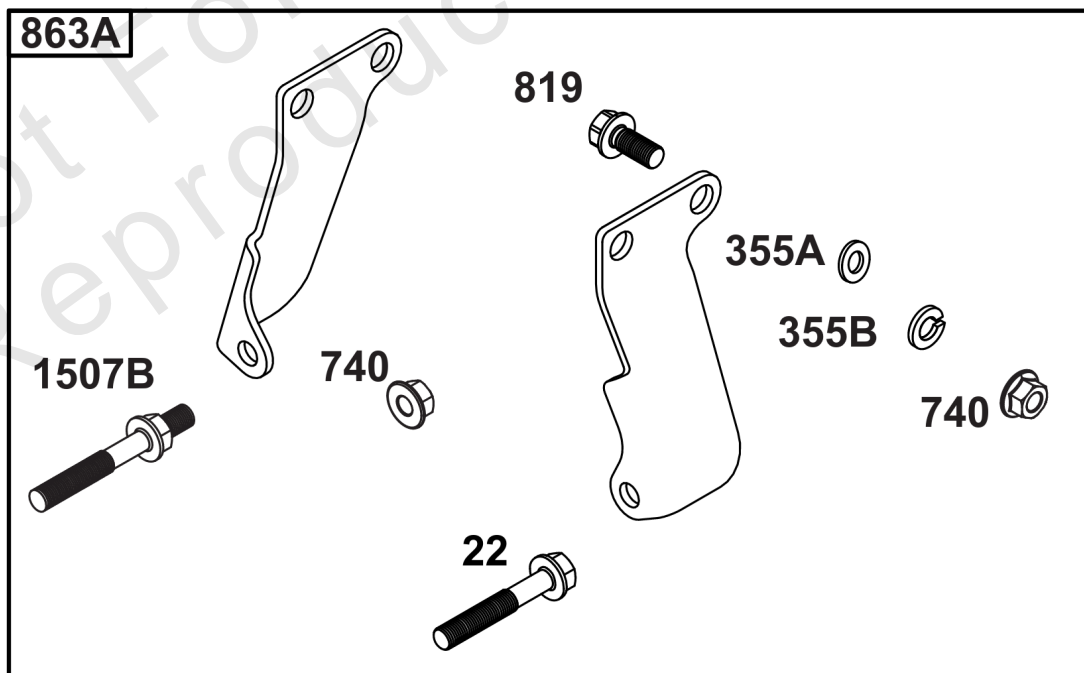
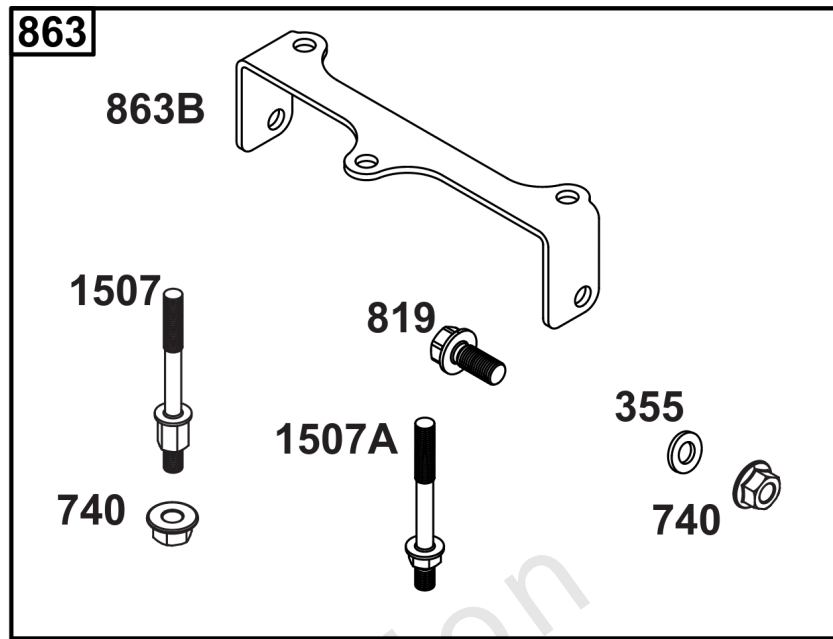

Muffler Bracket Kits

| REF NO | PART NO | QTY | DESCRIPTION |
|--------|---------|-----|-----------------------------------|
| 22 | 807362 | 2 | SCREW -(Muffler Bracket) |
| 355 | 844035 | 2 | WASHER -(Muffler Bracket) |
| 355A | 691261 | 2 | WASHER -(Muffler Bracket) |
| 355B | 691075 | 8 | WASHER -(Muffler Bracket) |
| 740 | 690941 | 6 | NUT -(Muffler Bracket) |
| 819 | 692062 | 2 | SCREW -(Muffler Bracket) |
| 863 | 848316 | 1 | BRACKET, Muffler -(Vertical) |
| 863A | 843487 | 1 | BRACKET, Muffler -(Horizontal) |
| 863B | 848296 | 1 | BRACKET, Muffler -(Vertical) |
| 1507 | 848297 | 1 | STUD -(Muffler Bracket) |
| 1507A | 848298 | 2 | STUD -(Muffler Bracket) |
| 1507B | 846324 | 2 | STUD -(Muffler Bracket) |

265

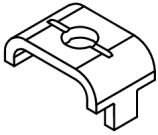

265A



416

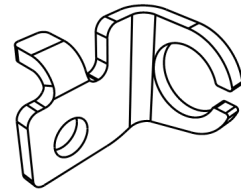

267

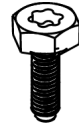

268

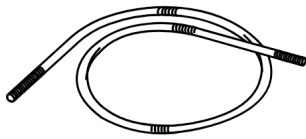

269

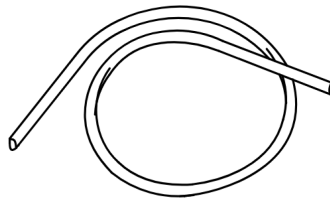

269A

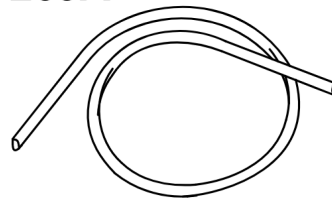

270

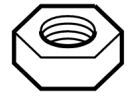

271

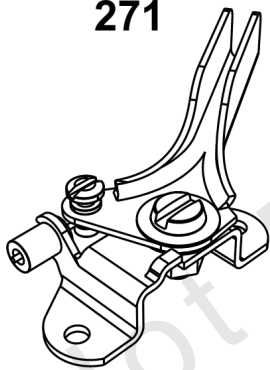

271A

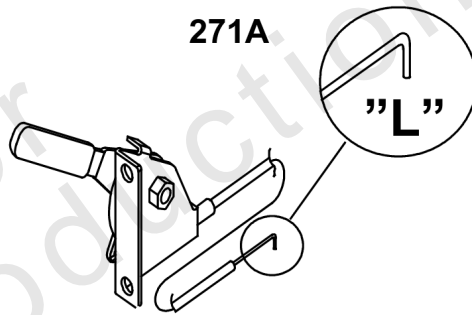

"L"

271B

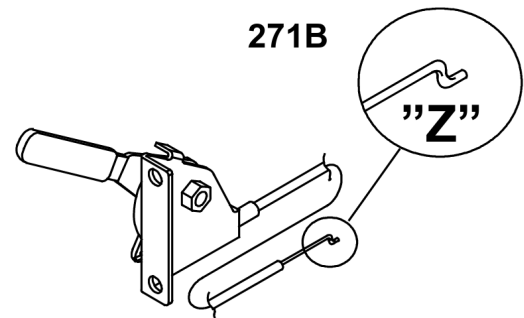

"Z"

1413

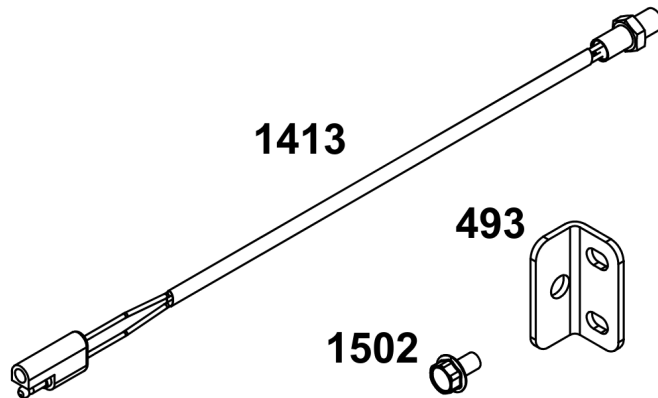

493

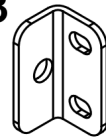

1502



Speed Control

| REF NO | PART NO | QTY | DESCRIPTION |
|--------|---------|-----|---|
| 265 | 691024 | 1 | CLAMP, Casing -(Casing Clamp for Hard Casing) |
| 265A | 690798 | 1 | CLAMP, Casing -(Casing Clamp for Soft Casing) |
| 267 | 792629 | 1 | SCREW -(Screw for Casing Clamp) |
| 268 | 691025 | 1 | CASING, Control Wire -(Wire Casing 72") |
| 269 | 691026 | 1 | WIRE, Control -(Control Wire 78") |
| 269A | 93907 | 1 | WIRE, Control -(Control Wire 100") |
| 270 | 691027 | 1 | NUT -(Nut for Wire Casing) |
| 271 | 691028 | 1 | LEVER, Control |
| 271A | 692105 | 1 | LEVER, Control -(Wire with "L" formed end) |
| 271B | 692541 | 1 | LEVER, Control -(Wire with "Z" formed end) |
| 416 | 595196 | 1 | BRACKET, Throttle Cable -(Casing Clamp for Snap-In Casing) |
| 493 | 842713 | 1 | BRACKET, Mounting -(Speed Sensor) |
| 1413 | 844449 | 1 | SENSOR, Speed -(Requires 842713 Bracket and two 841233 screws) |
| 1502 | 841233 | 2 | SCREW -(Speed Sensor) |



Electrical

| REF NO | PART NO | QTY | DESCRIPTION |
|--------|-----------|-----|--|
| 330 | 847476 | 1 | SENSOR, Oxygen -(Extended Length O2 Sensor 23.5") |
| 415 | 1714480SM | 1 | PLUG -(Plug for Ignition Switch Removal) |
| 789 | 809967 | 1 | HARNESS, Wiring -(Wire Harness Extension 8 Pin – 22") (Use with standard key switch 692318 or water/dust resistant key switch 847448) |
| 789A | 846776 | 1 | HARNESS, Wiring -(Wire Harness Extension 6 Pin – 22") (Use with standard key switch 692318 or water/dust resistant key switch 847448) |
| 789B | 847017 | 1 | WIRE ASSEMBLY -(Wire Harness Extension for 847016 Tach 32") |
| 853 | 80028618 | 1 | ADAPTER, Wire -(Wire Harness Adapter 6 Pin to 8 Pin) |
| 983 | 5103809YP | 1 | LIGHT, Indicator -(MIL Light Indicator, LED Red) |
| 1518 | 847016 | 1 | TACHOMETER -(Tach, Hour Meter with MIL Light for EFI Engines) |
| 1616 | 19626 | 1 | CODE READER -(Tiny Scan) |

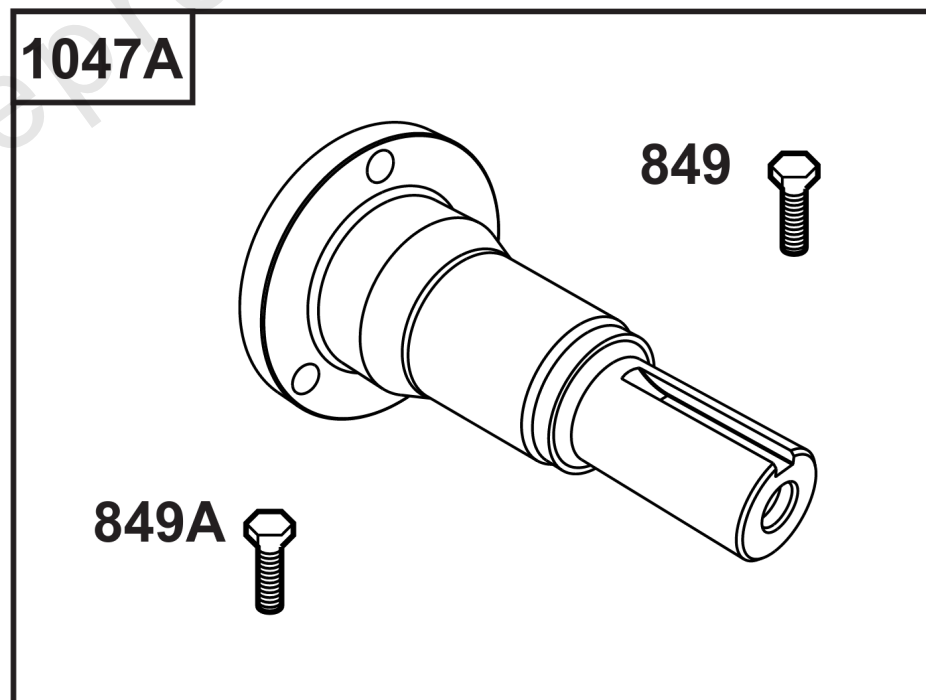
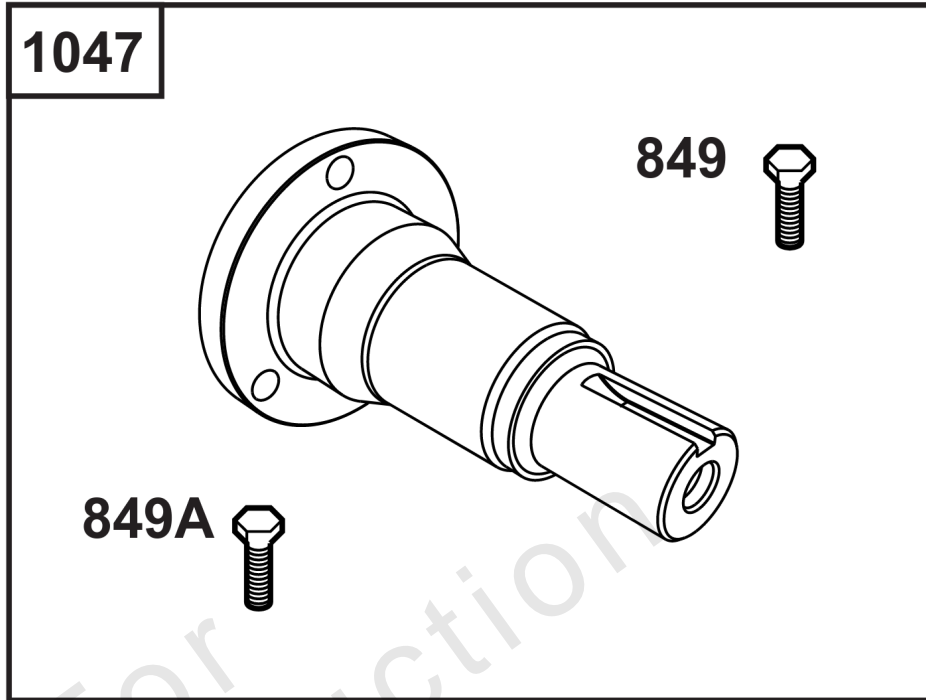

Stub Shafts

| REF NO | PART NO | QTY | DESCRIPTION |
|--------|---------|-----|---|
| 849 | 596370 | 3 | SCREW -(Stub Shaft) |
| 849A | 846235 | 3 | SCREW -(Stub Shaft) |
| 1047 | 841304 | 1 | SHAFT, Stub -(Flywheel Mounted) (1-1/8" diameter, 148 mm length) |
| 1047A | 843342 | 1 | SHAFT, Stub -(Flywheel Mounted) (1-1/8" diameter, 176 mm length) |

Not For Reproduction

613

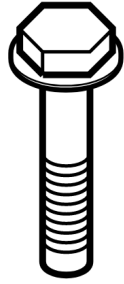

437

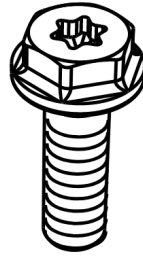

151

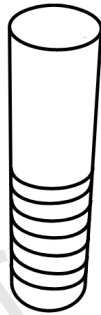

1177

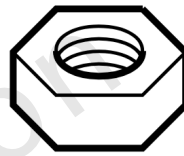

883

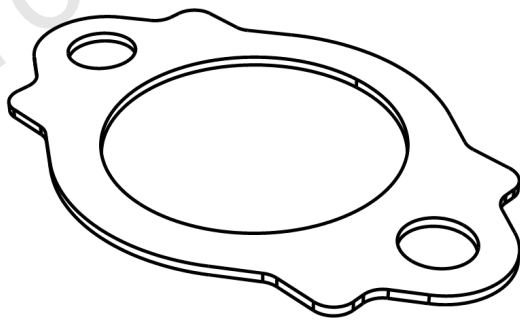

994

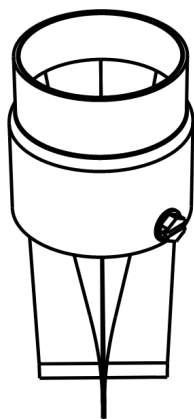

301

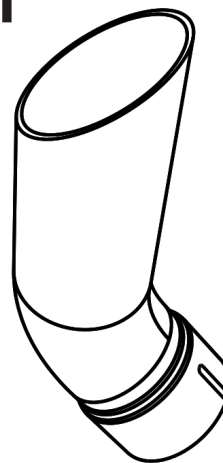

Spark Arrester/Deflector

| REF NO | PART NO | QTY | DESCRIPTION |
|--------|---------|-----|---|
| 151 | 841185 | 4 | STUD -(4 per engine) |
| 301 | 841518 | 1 | PIPE, Exhaust -(For 44.7 O.D. muffler outlet pipe) (Requires clamp 843624) |
| 437 | 809743 | 4 | SCREW -(M8 x 25 for Mounting Mufflers) (4 per engine) |
| 613 | 692062 | 4 | SCREW -(M8 x 18 for Mounting Mufflers) (4 per engine) |
| 883 | 809872 | 2 | GASKET, Exhaust -(2 per engine) |
| 994 | 843204 | 1 | ARRESTOR, Spark -(1.75") (44.7 mm) (O.D. Outlet Tube) |
| 1177 | 842067 | 4 | NUT -(Required if using 841185 stud) |

Not For Reproduction

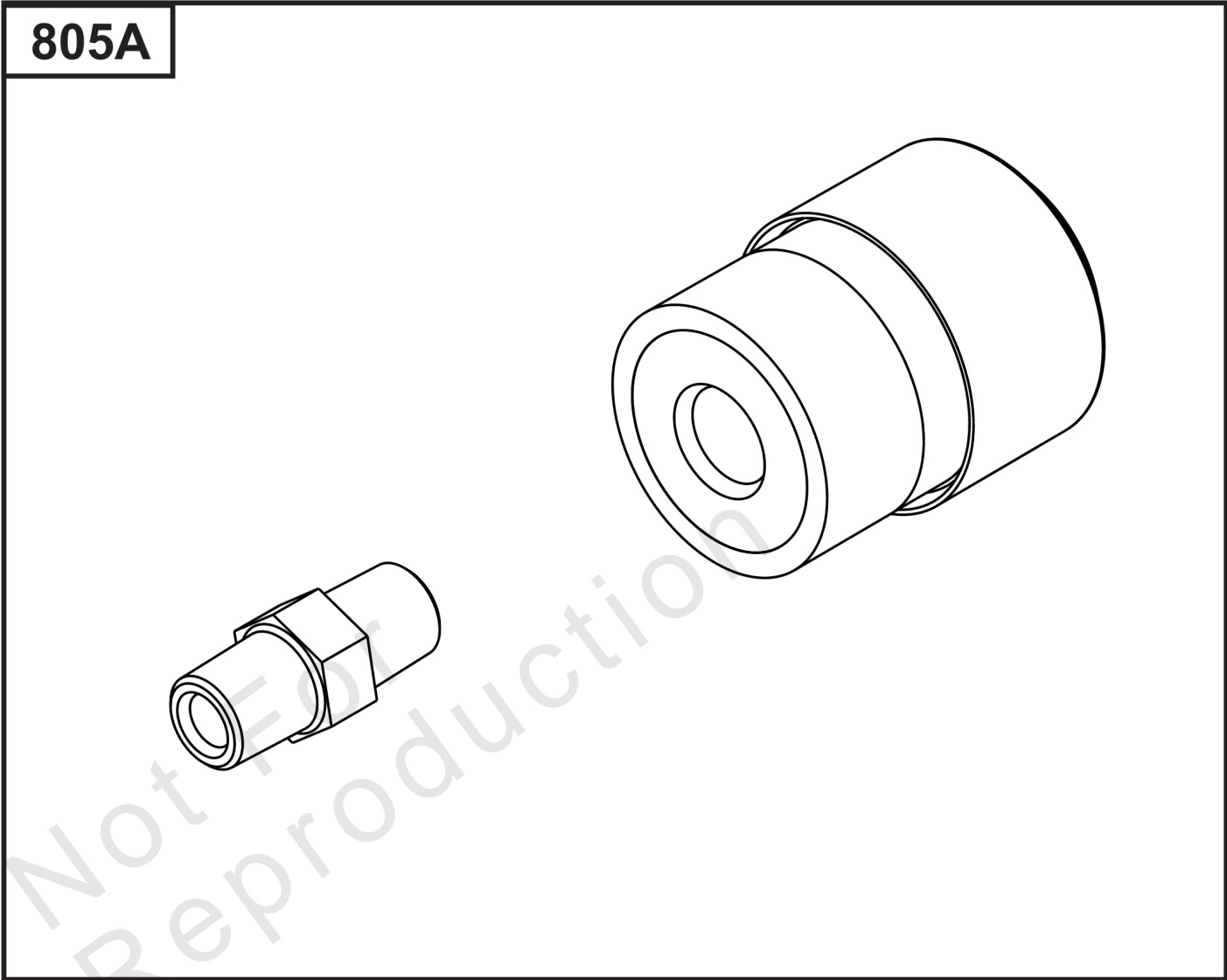

Air Intake

| REF NO | PART NO | QTY | DESCRIPTION |
|--------|---------|-----|----------------|
| 805A | 843024 | 1 | MINDER, Filter |

Not For Reproduction

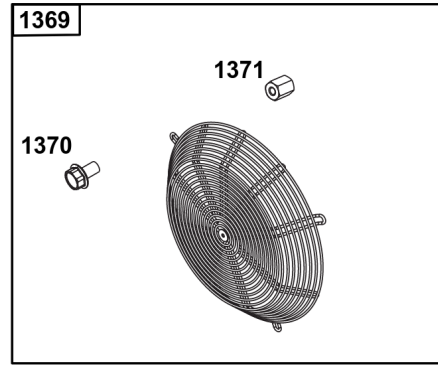
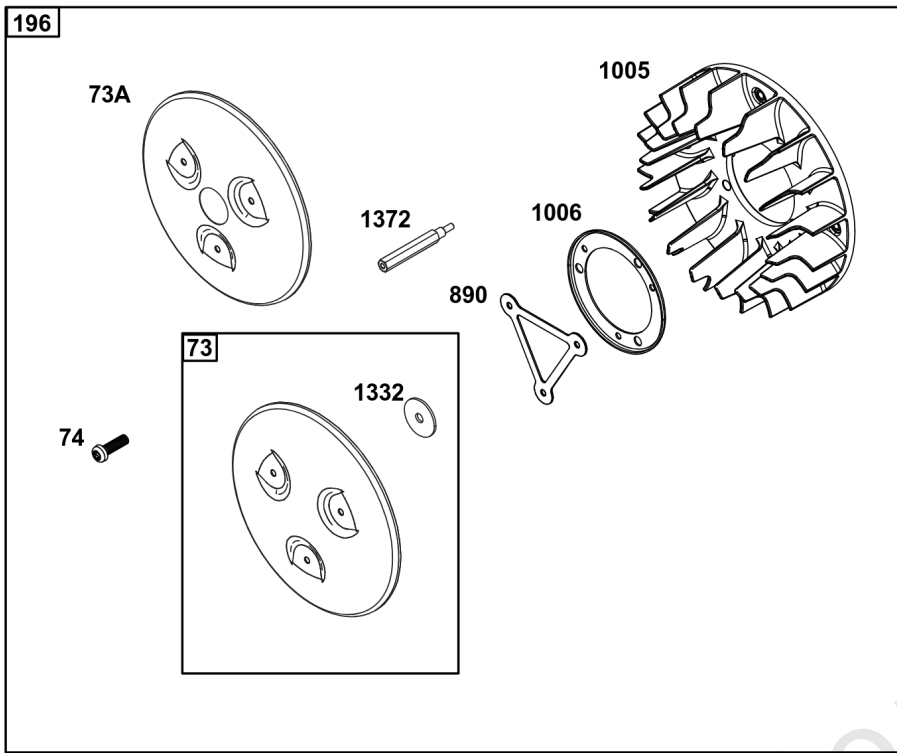

Not For
Reproduction

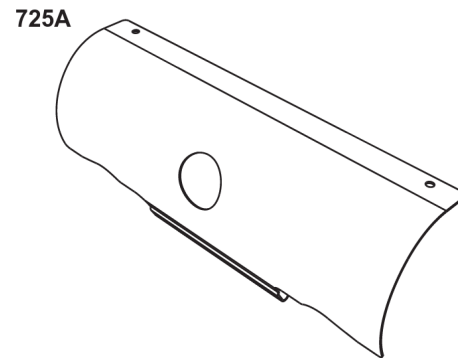
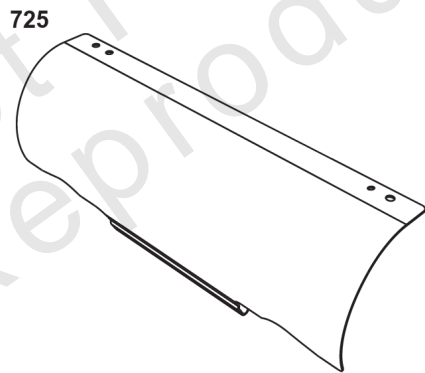

Guarding

| REF NO | PART NO | QTY | DESCRIPTION |
|--------|---------|-----|--|
| 73 | 841840 | 1 | SCREEN, Rotating |
| 73A | 842248 | 1 | SCREEN, Rotating |
| 74 | 809947 | 3 | SCREW -(Rotating Screen) (M6x20mm) |
| 196 | 847200 | 1 | GUARD, Flywheel Fan |
| 725 | 841132 | 1 | SHIELD, Heat -(Requires 2 x 692067 Screw) |
| 725A | 847229 | 1 | SHIELD, Heat -(With 02 Sensor Hole) (EFI) |
| 890 | 809987 | 1 | BRACKET, Support |
| 1005 | 846996 | 1 | FAN, Flywheel |
| 1006 | 847198 | 1 | RETAINER, Fan |
| 1332 | 809948 | 3 | WASHER |
| 1369 | 995019 | 1 | FAN/SCREEN ASSEMBLY |
| 1370 | 841233 | 4 | SCREW -(Flywheel Fan Guard) |
| 1371 | 841537 | 4 | NUT -(Flywheel Fan Guard) |
| 1372 | 809946 | 3 | STUD |

Not For Reproduction

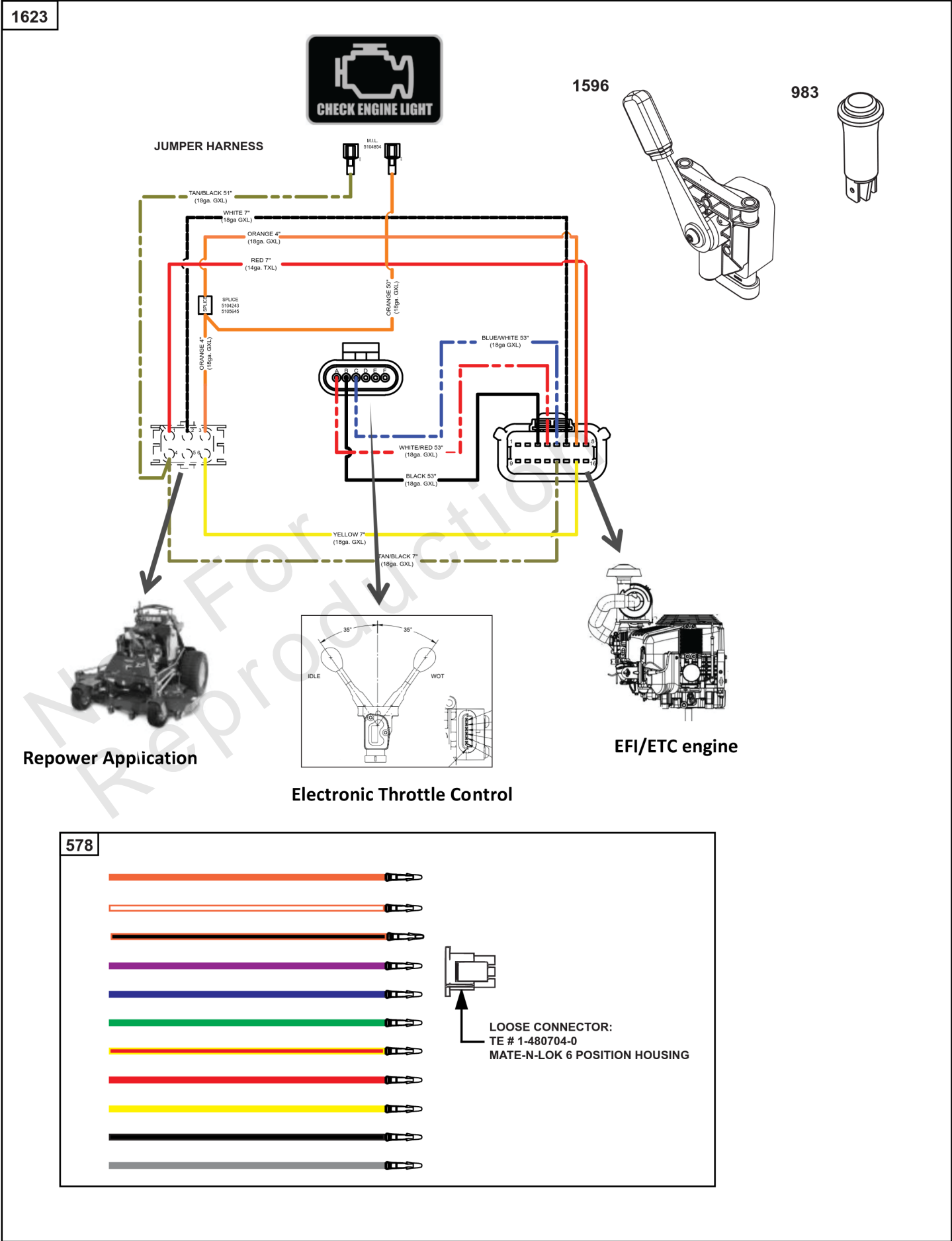

Electronic Throttle Kit

| REF NO | PART NO | QTY | DESCRIPTION |
|---------------|----------------|------------|---|
| 578 | 84007350 | 1 | WIRE ASSEMBLY |
| 983 | 5103809YP | 1 | LIGHT, Indicator |
| 1596 | 84007271 | 1 | LEVER, Electronic Throttle |
| 1623 | 84008670 | 1 | KIT, Throttle Assembly -(Analog Electronic Throttle Control) |

Not For Reproduction

WANGUARD[®]

COMMERCIAL POWER



BRIGGS & STRATTON[®]